



SeceuroGlide Sectional Plus Fitting Instructions



SeceuroGlide | Sectional Plus
Front Mounted System

Fitter's Information Pack - SeceuroGlide Sectional Plus

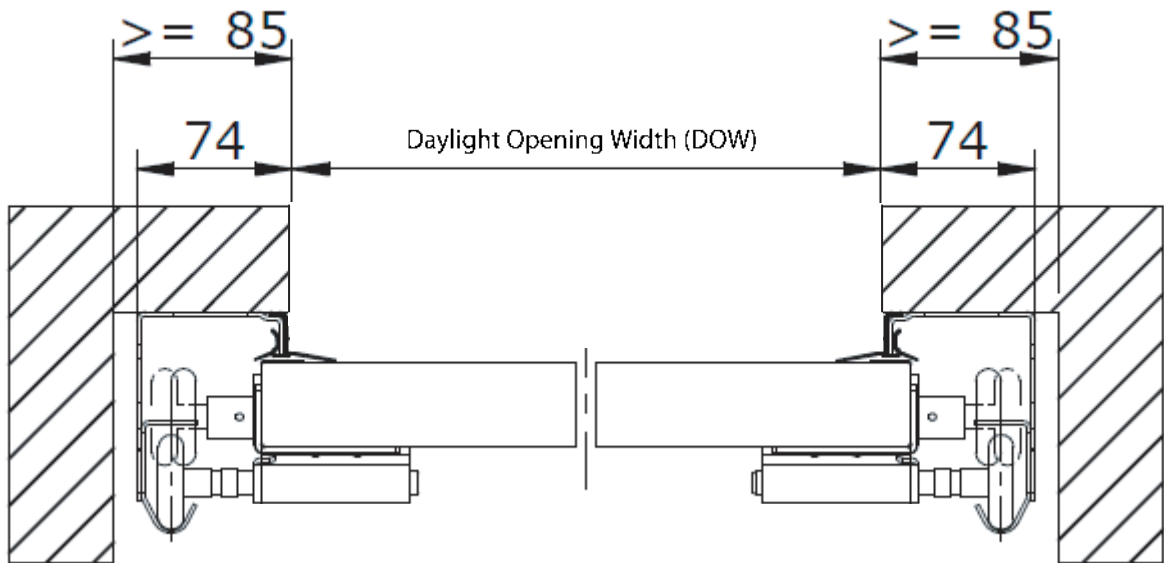
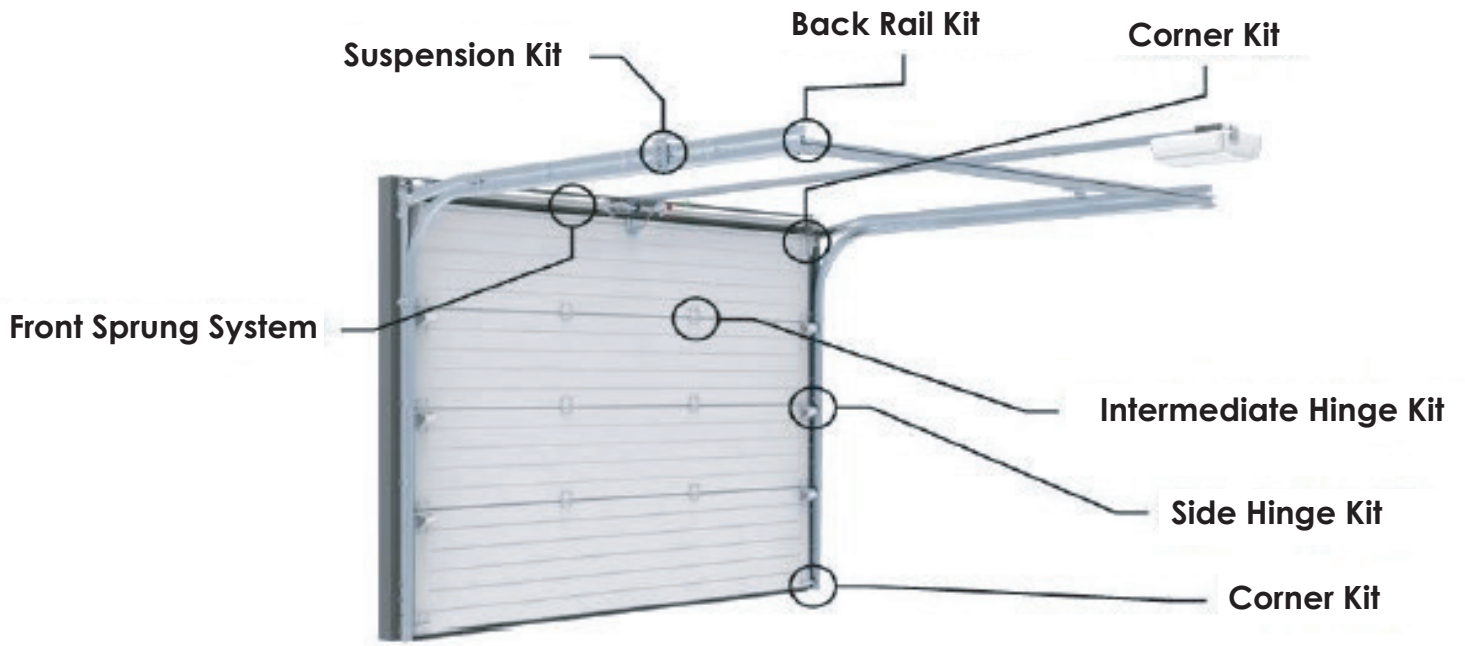

✓ EN 12604

✓ EN 12453

✓ EN 13241

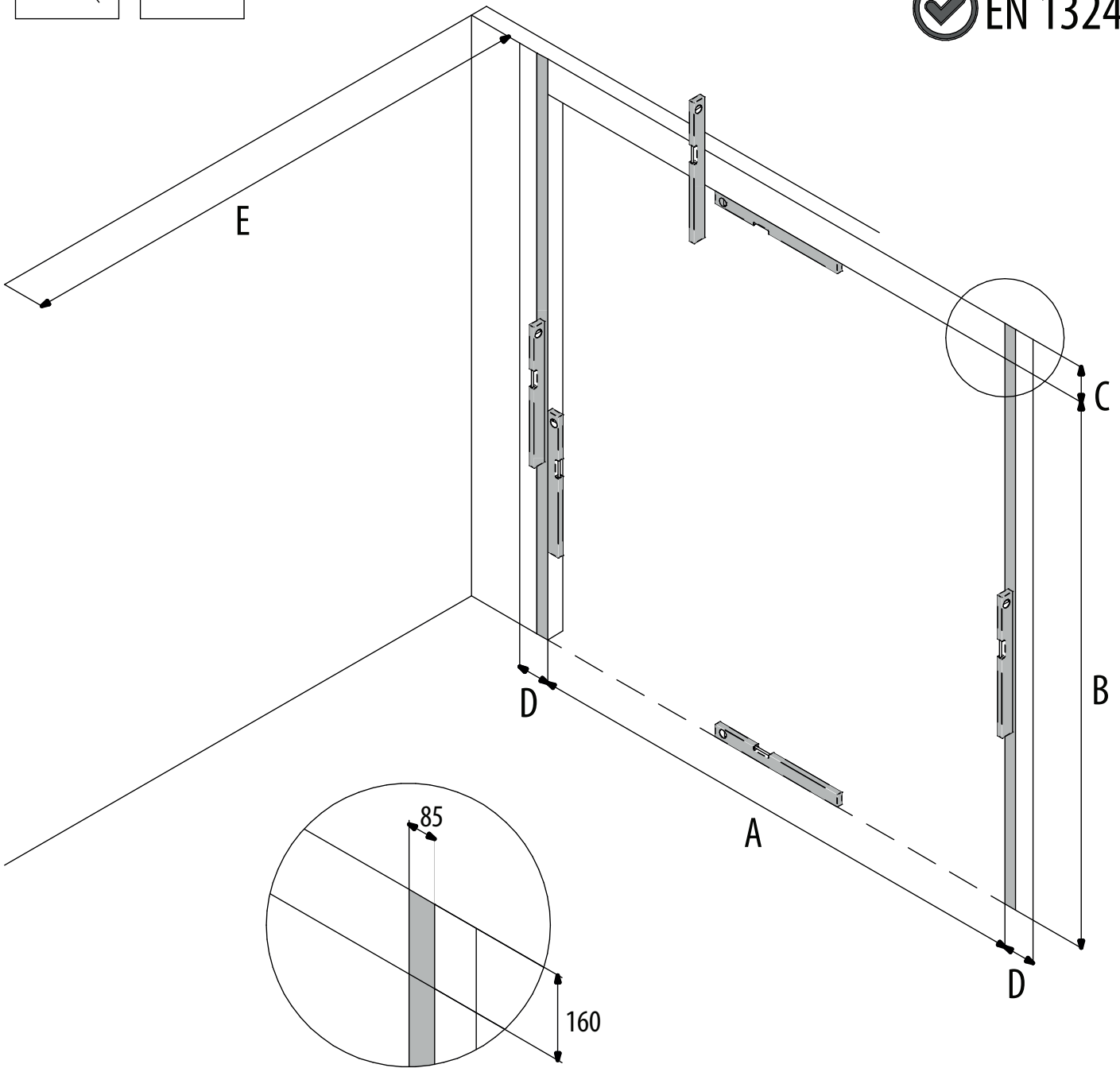
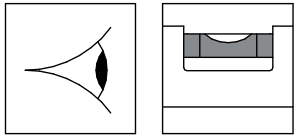

A	B	C	D	E
DLW	DLH	FHR	FSR	FMD
Daylight Width	Daylight Height	Free Head Room	Free Side Room	Free Mounting Depth

Seals are 100mm larger than needed,
cut down to suit the opening

Slide weather seals onto
vertical tracks

Bolt front spring support
bracket to vertical track

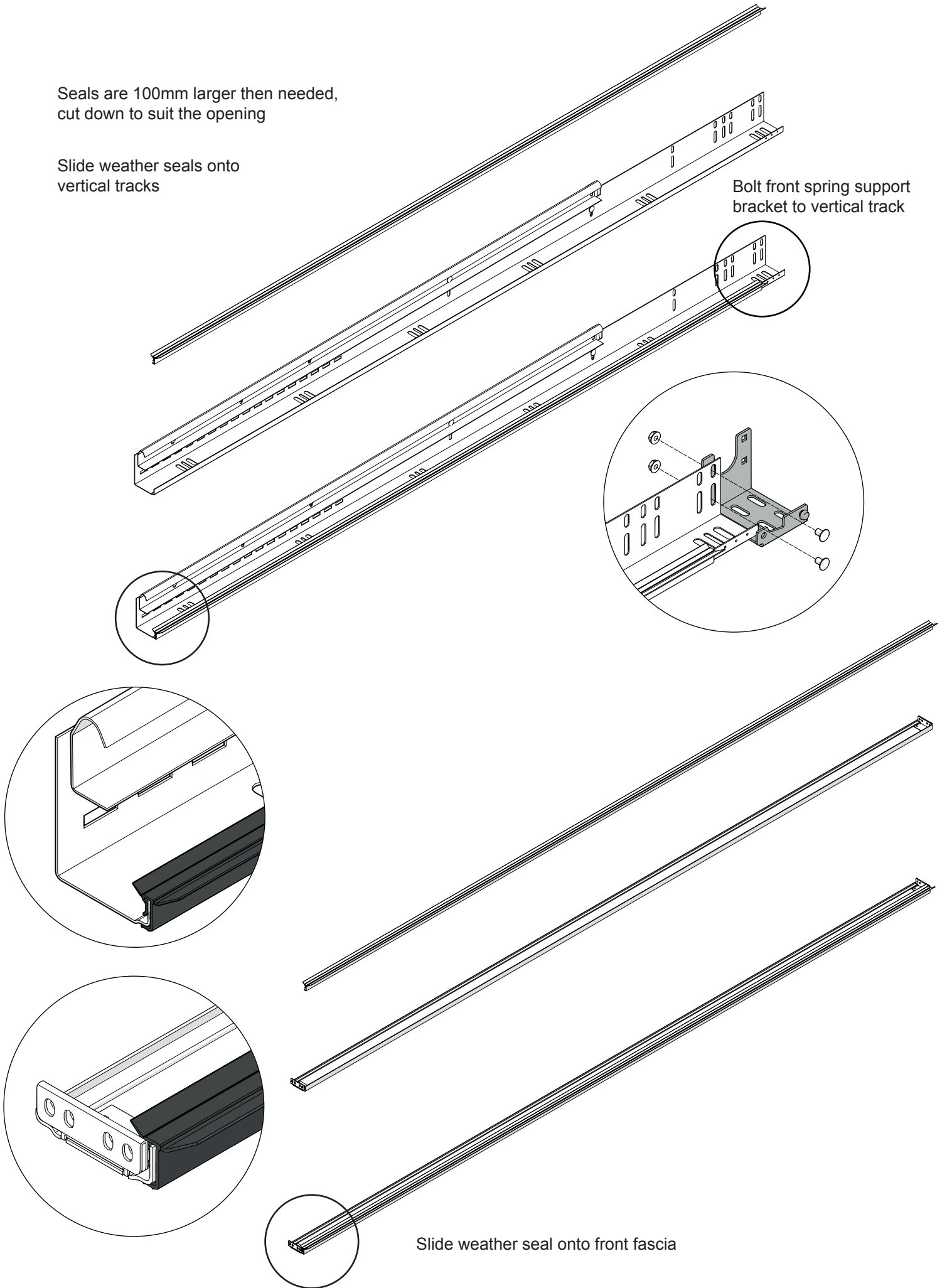

Slide weather seal onto front fascia

Assemble top tracks as below

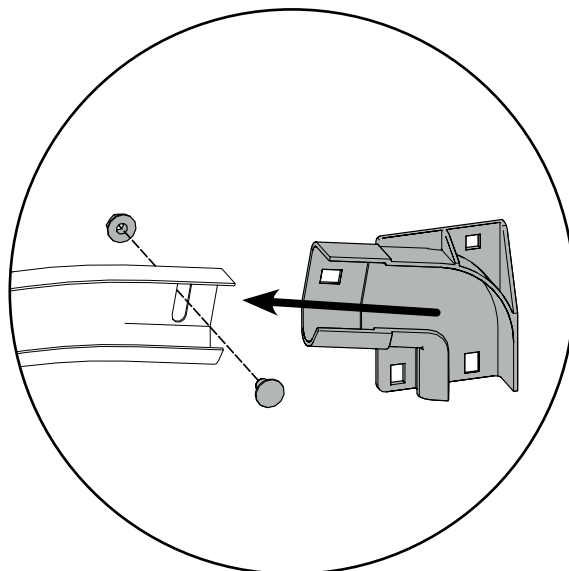
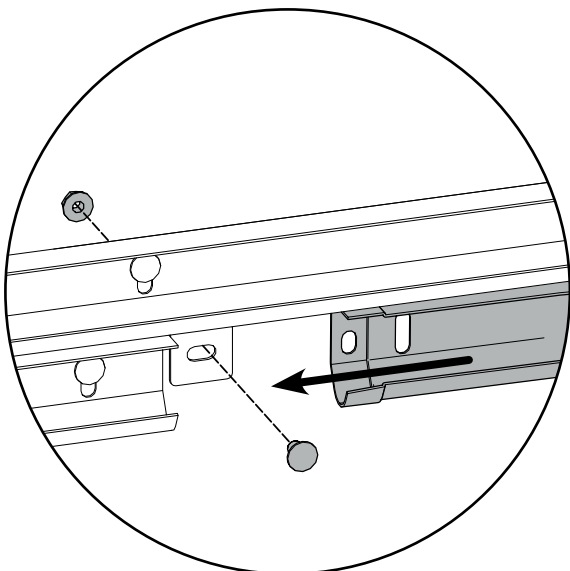
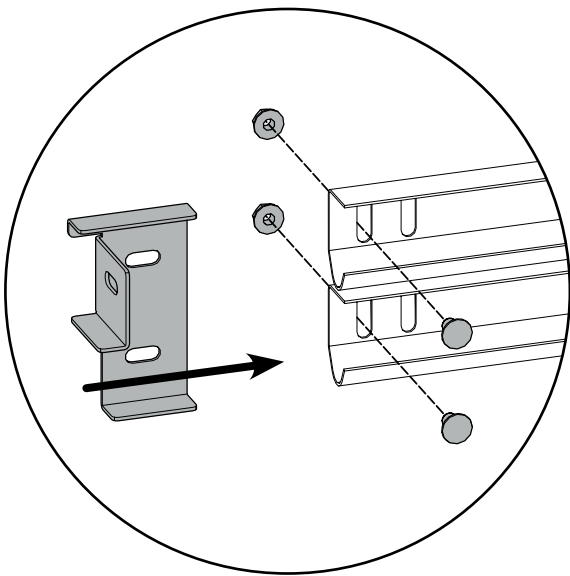
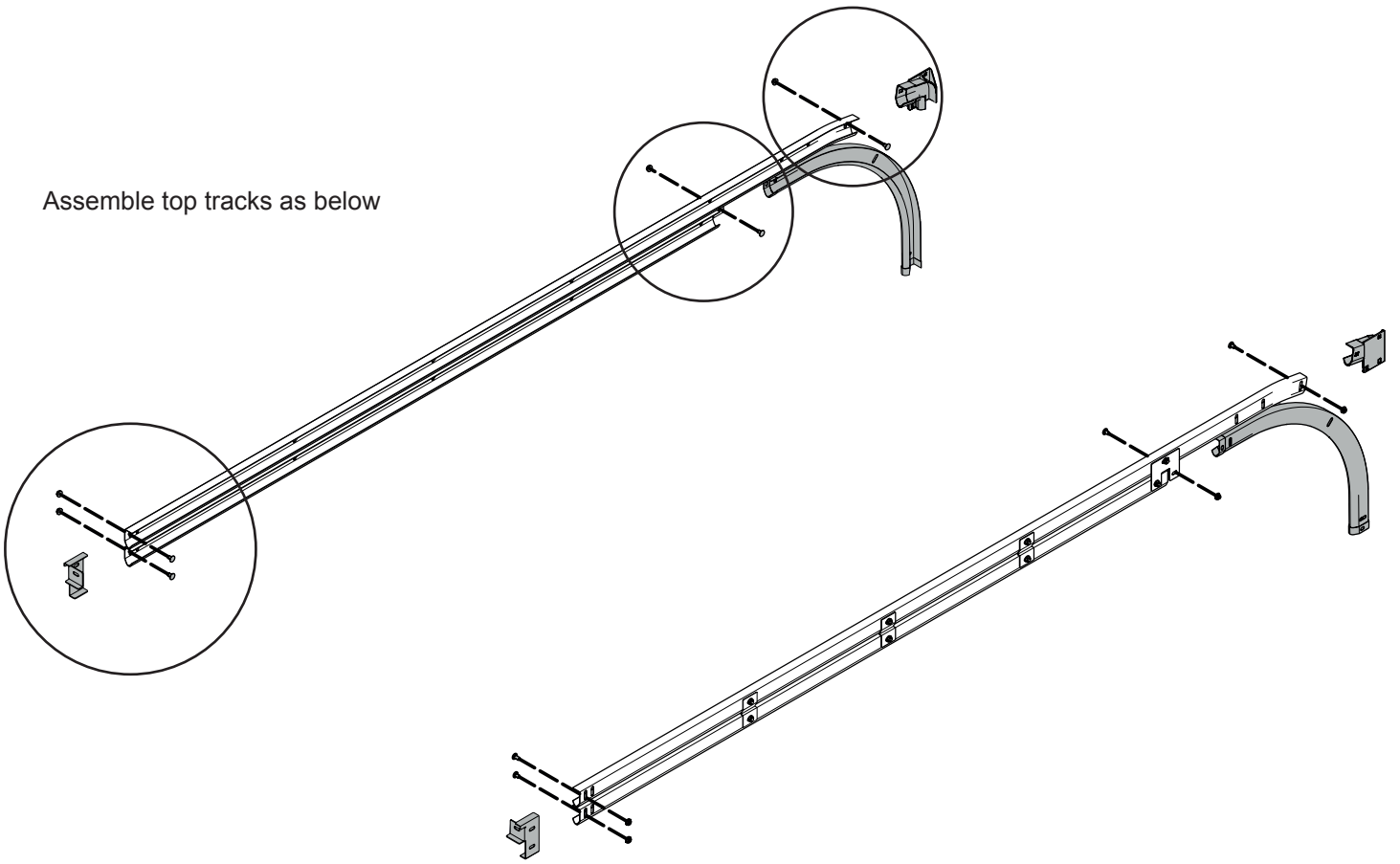

Lift the fascia into place and secure

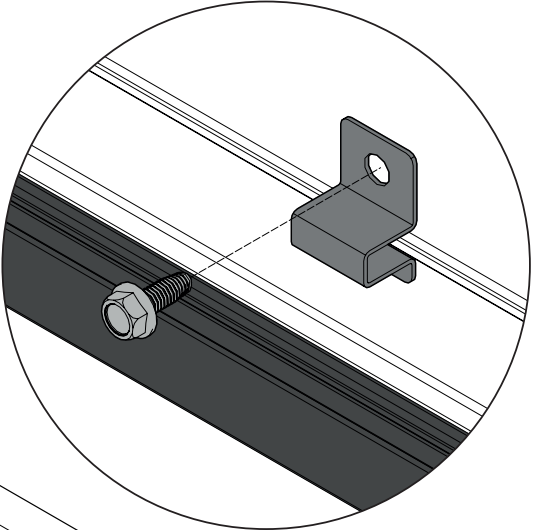
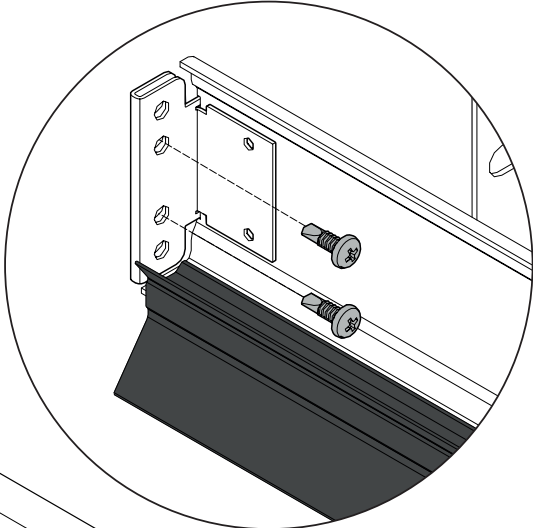

Clamp tracks to the wall

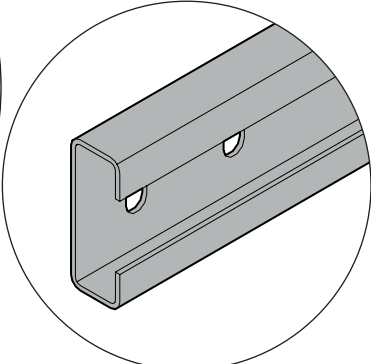
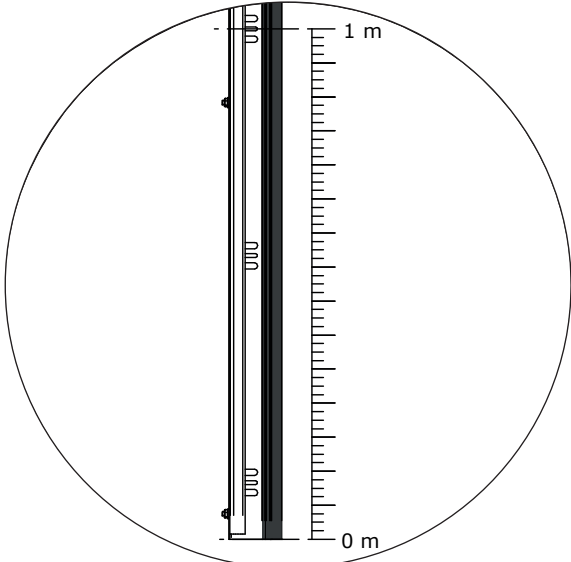
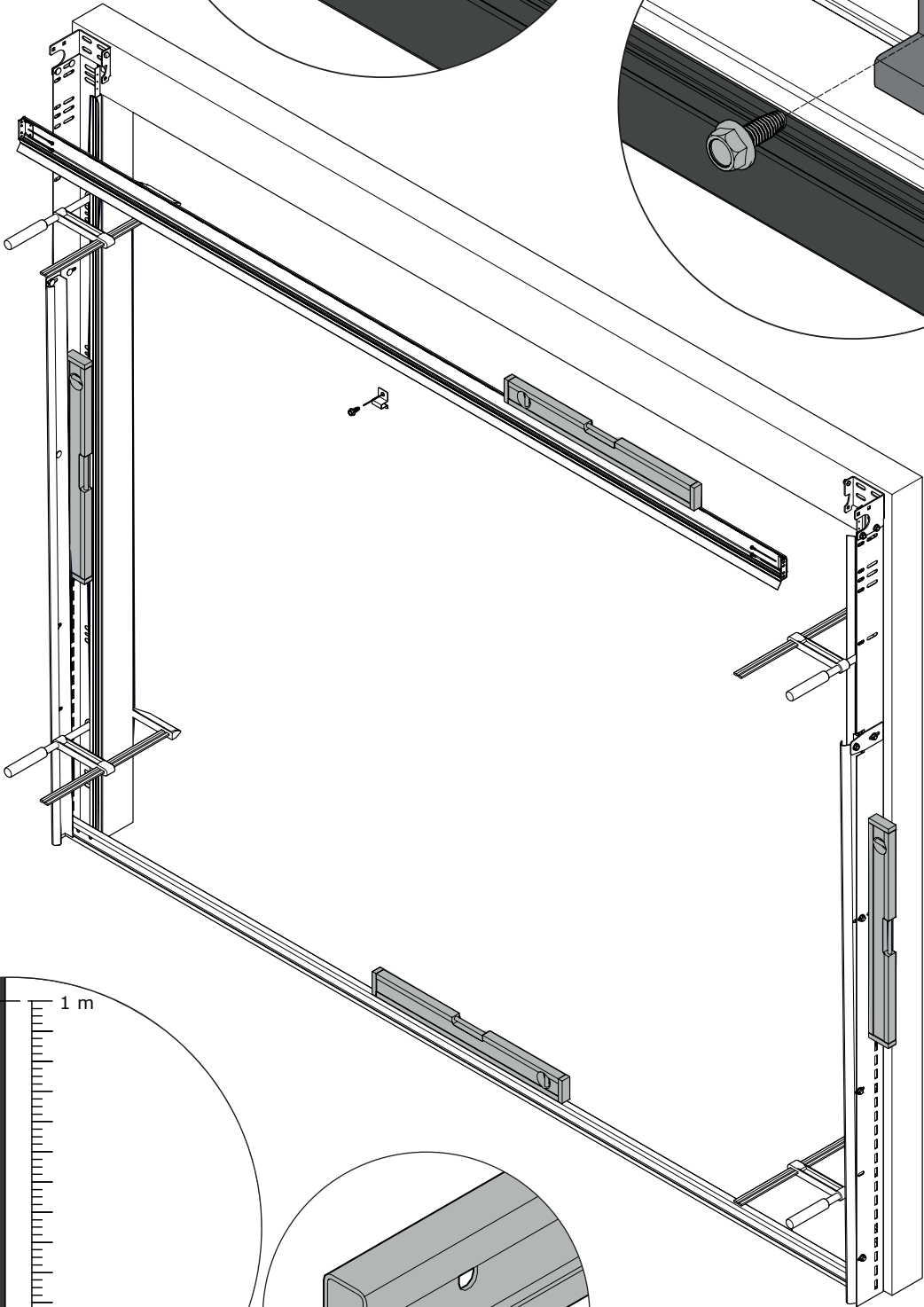

Insert the back bar between angles to determine the track width

Once the frame is level, secure with the fixings below.

Ø8

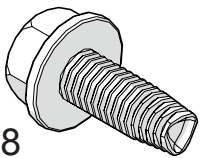

Ø6

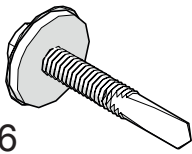

Ø8

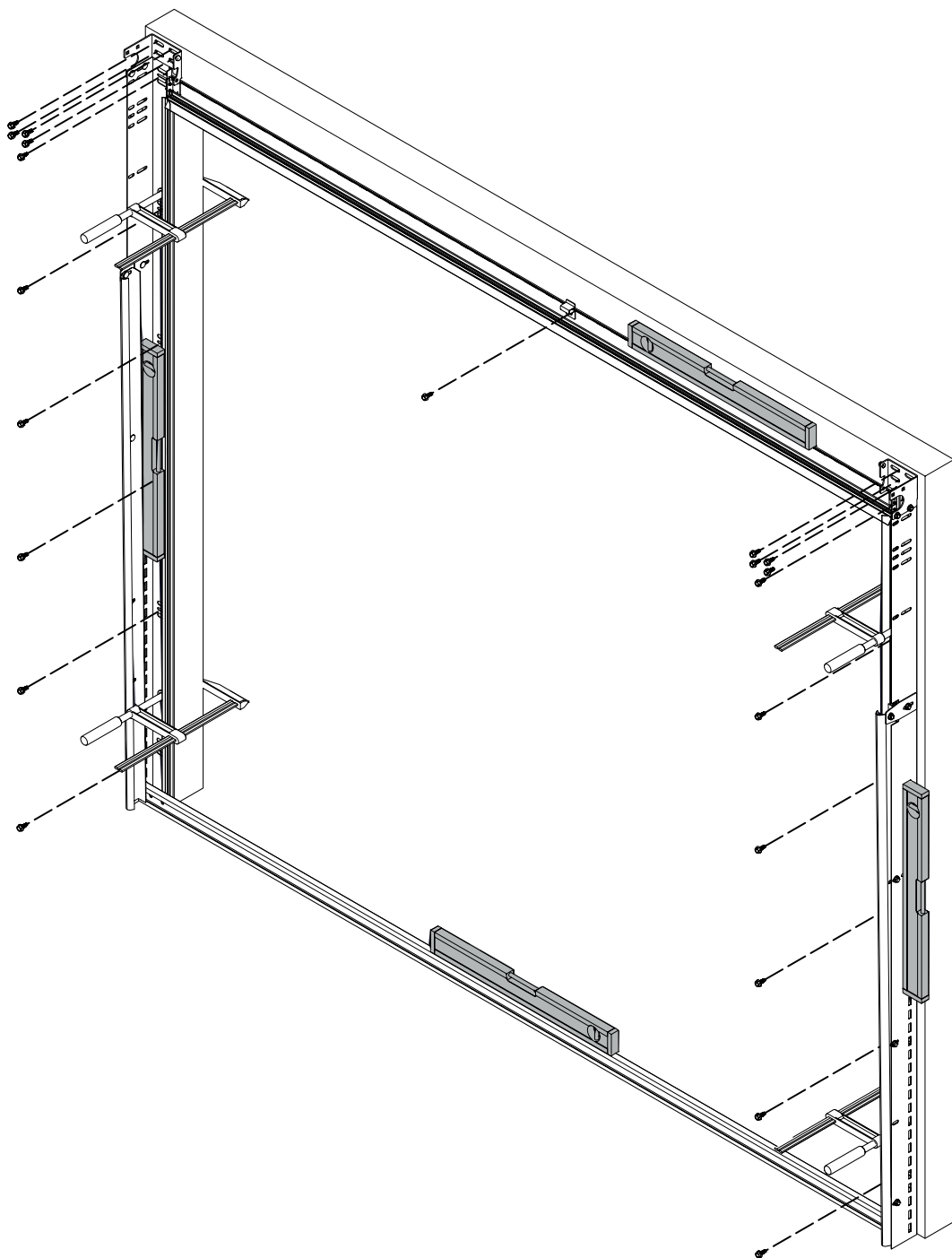
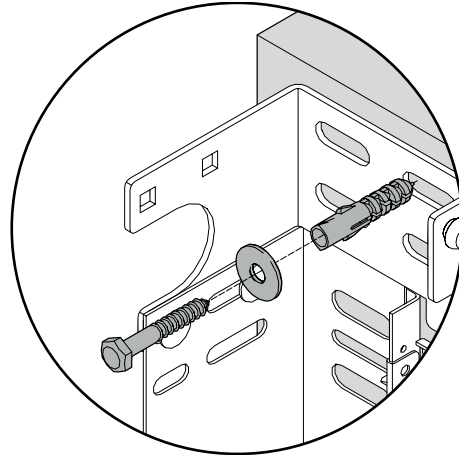
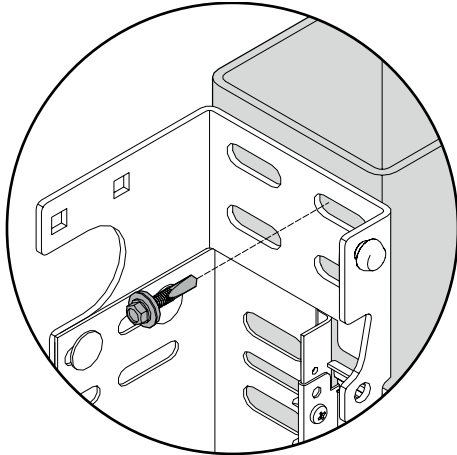
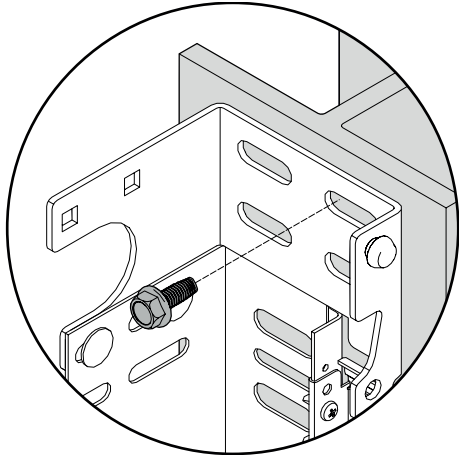
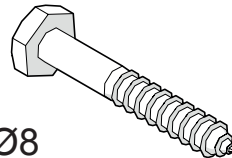

Assemble horizontal tracks as shown

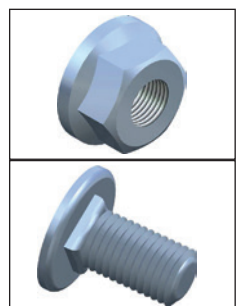
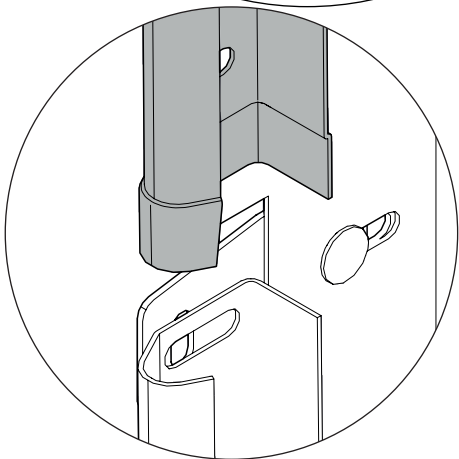
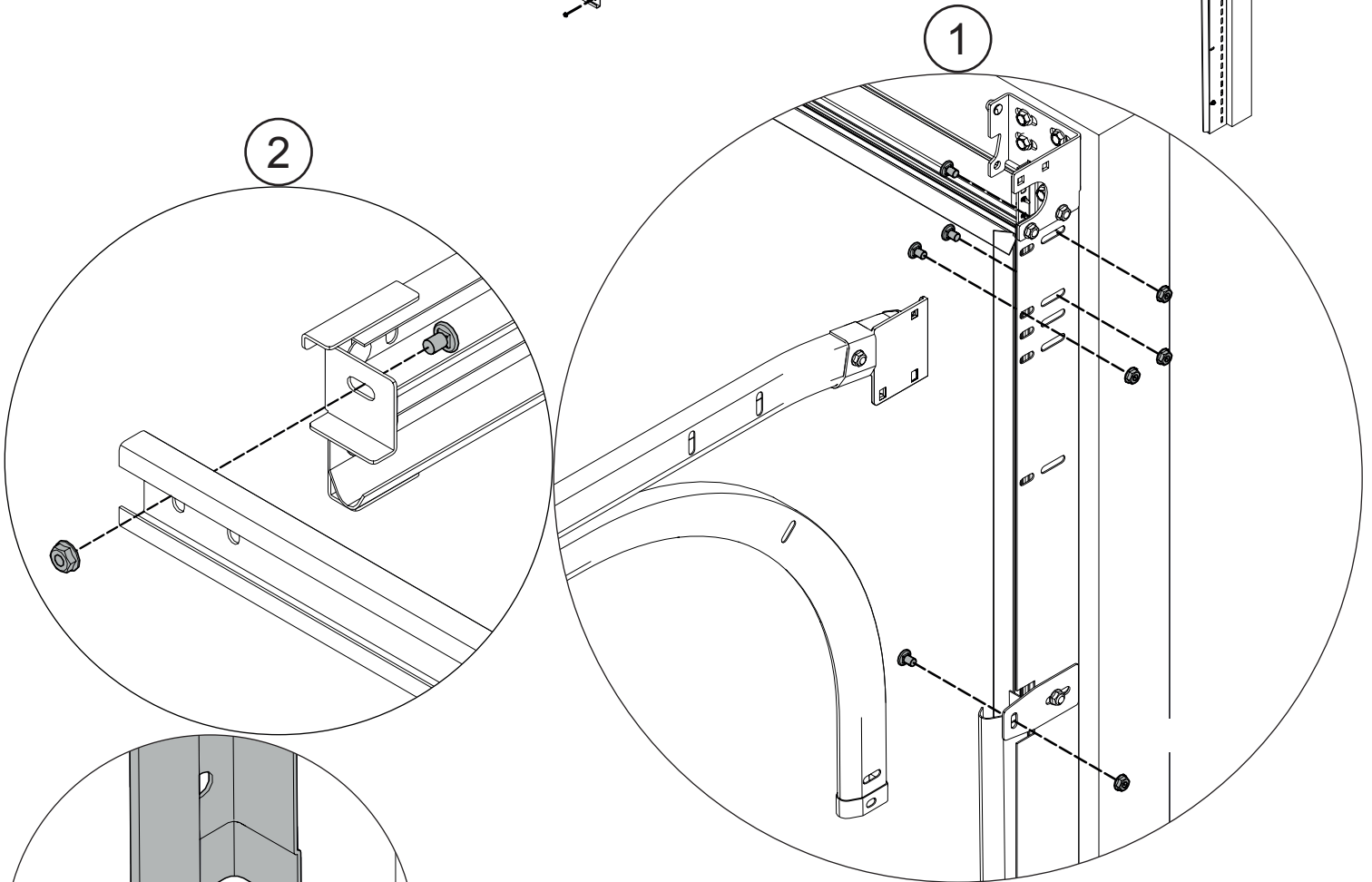
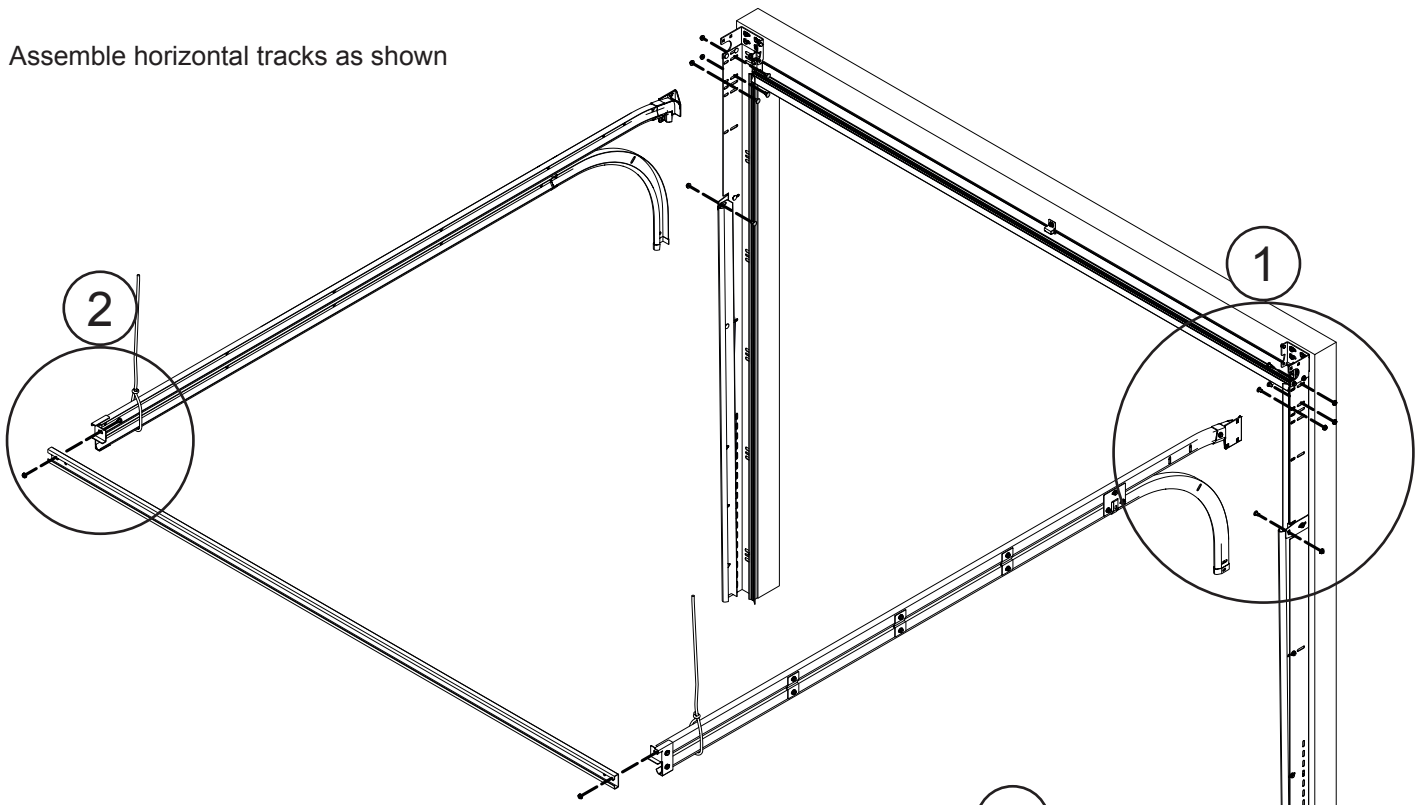

Measure from corner to corner to determine if the horizontal track area is square, adjust accordingly. Before securing the L shape hangers, ensure the horizontal tracks are level

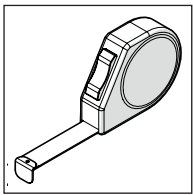
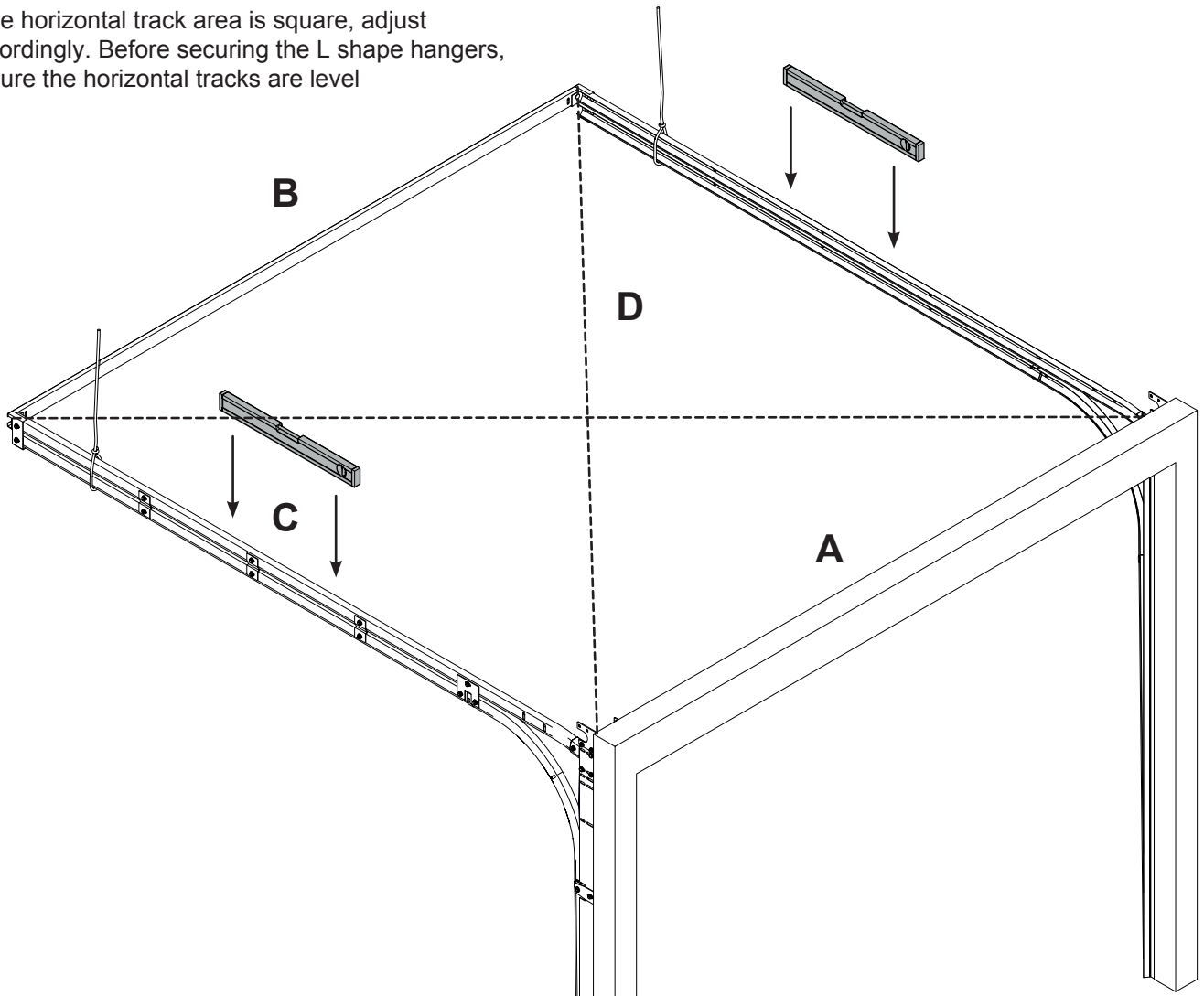

$A = B$
 $C = D$

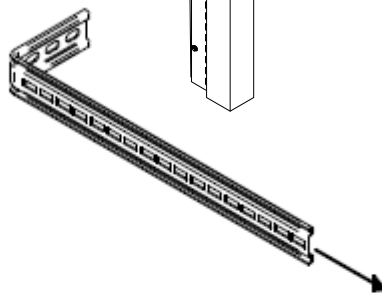
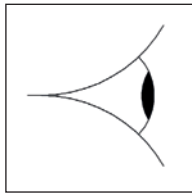
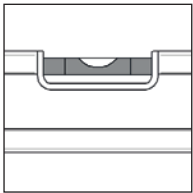

Using the L shape hangers and the clamping brackets secure the back bar to neighbouring walls

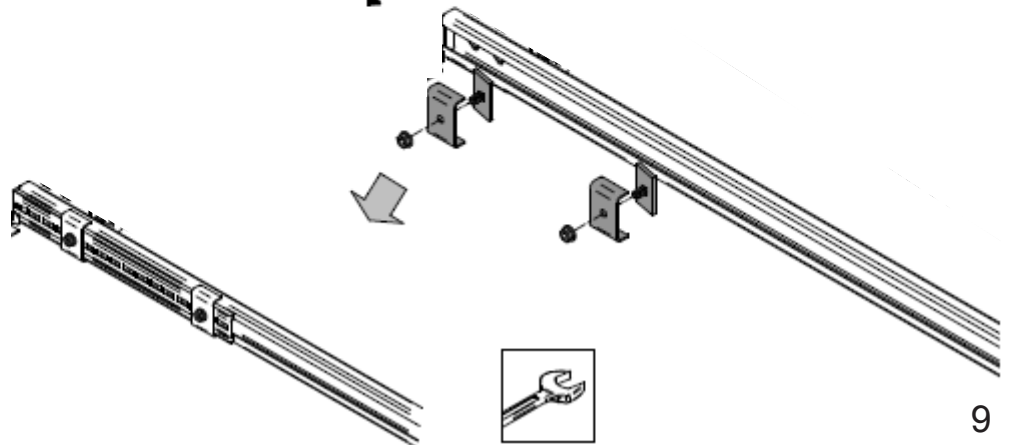

Fit L shape hanger to horizontal track and position to underside of adequate fixing point

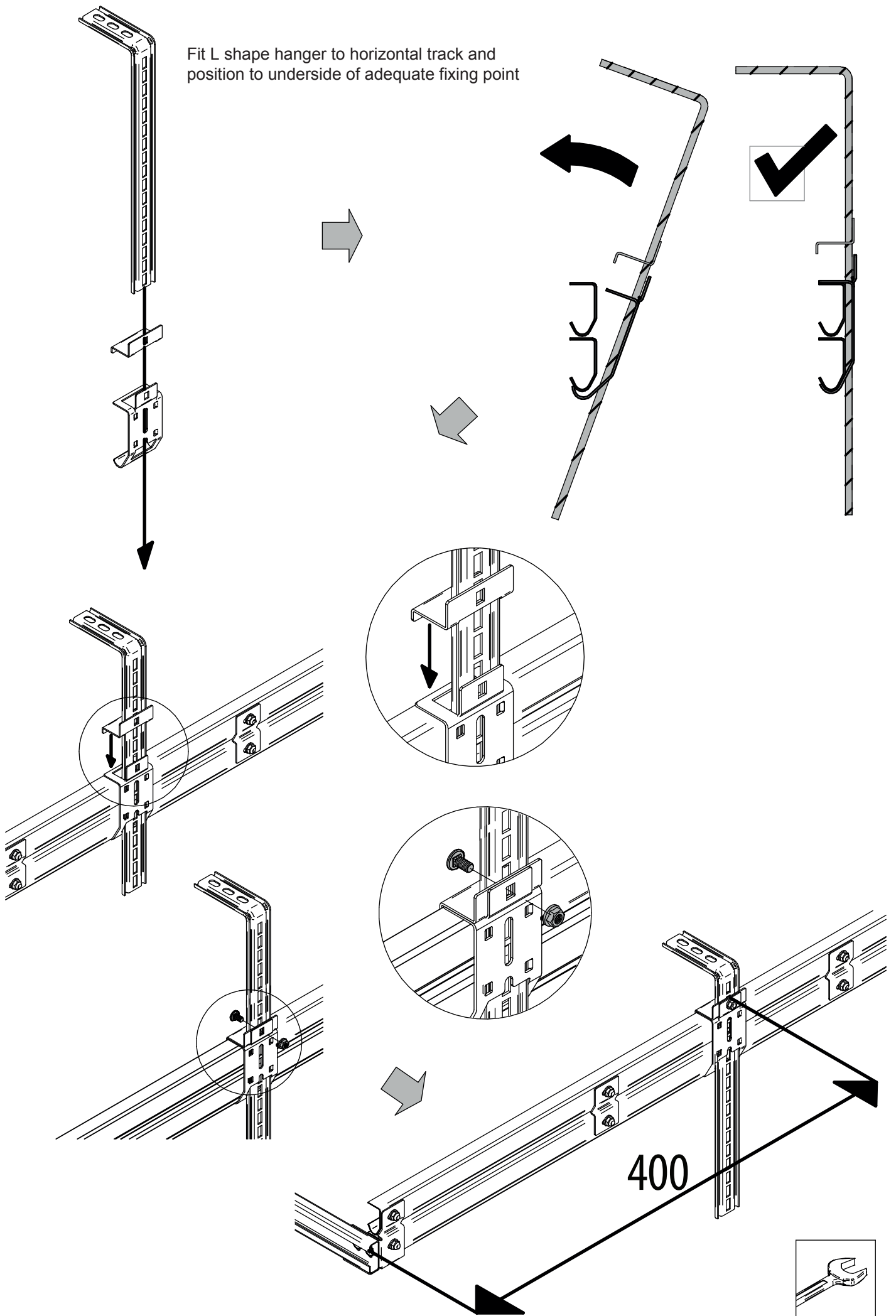

Join the front bar together.
Lift and secure into place and
secure onto the front mounted
brackets

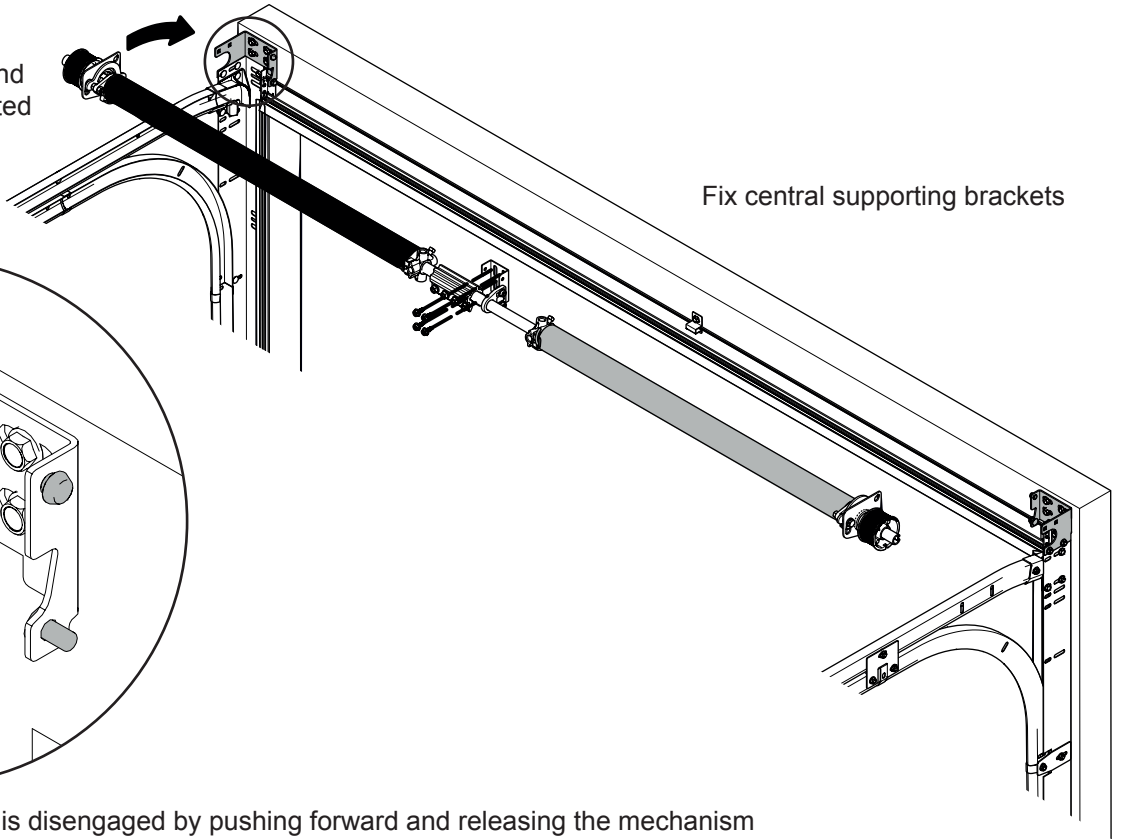

Fix central supporting brackets

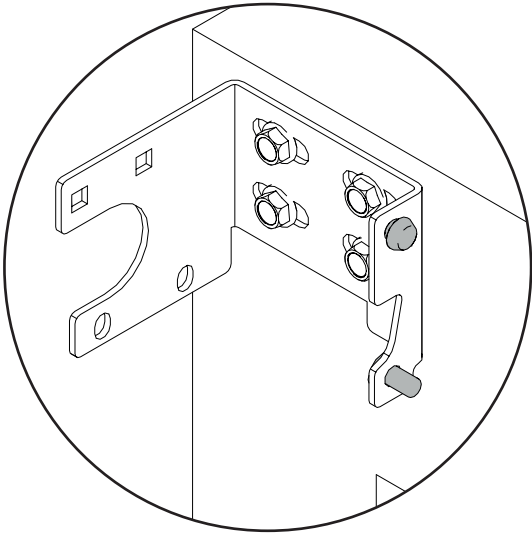

Ensure that the safety brake is disengaged by pushing forward and releasing the mechanism

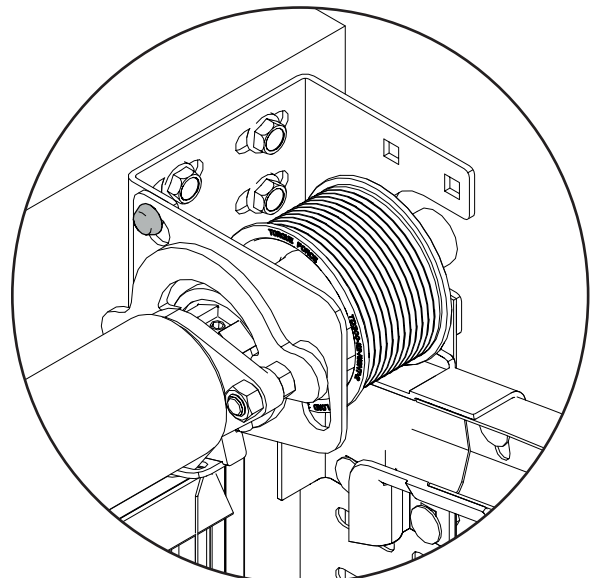
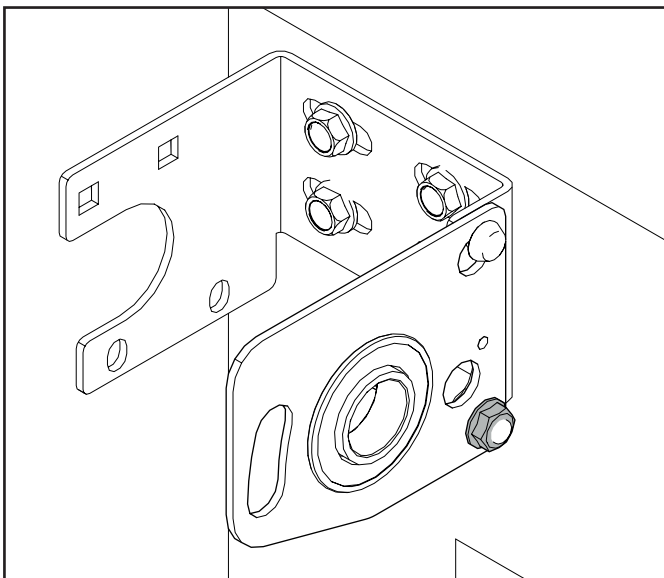
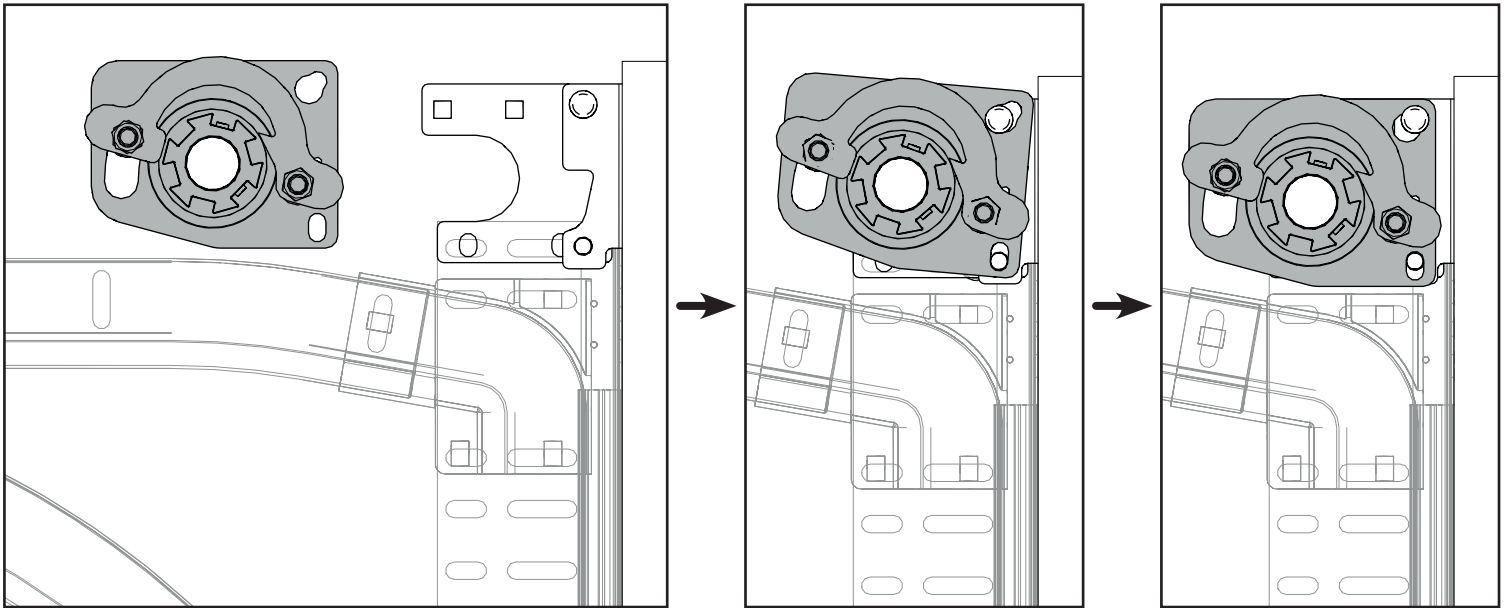

Once the spring mechanism has been fitted, use an M8 nut to secure the components together

Lift the bottom panel into the opening

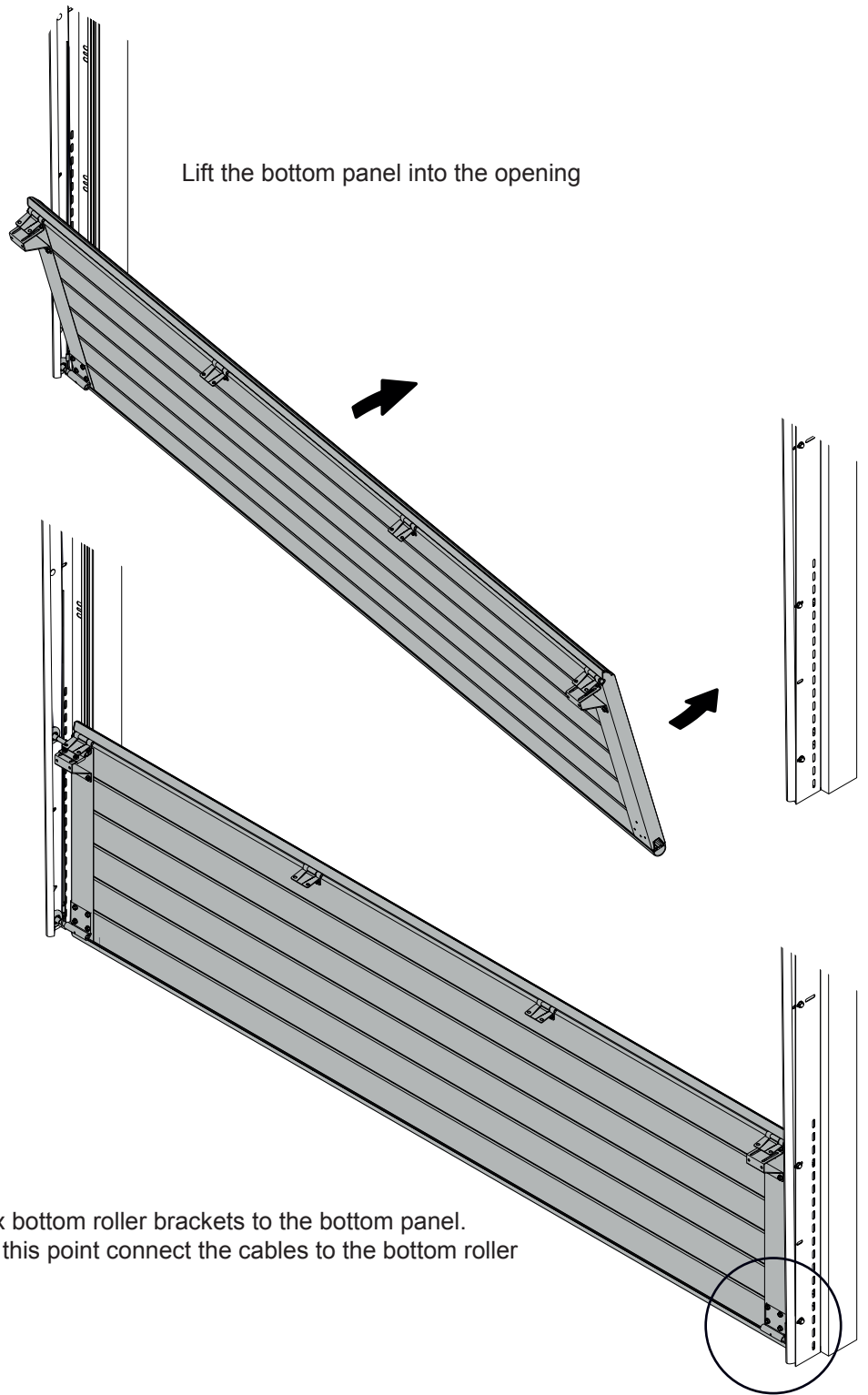

Fix bottom roller brackets to the bottom panel.
At this point connect the cables to the bottom roller

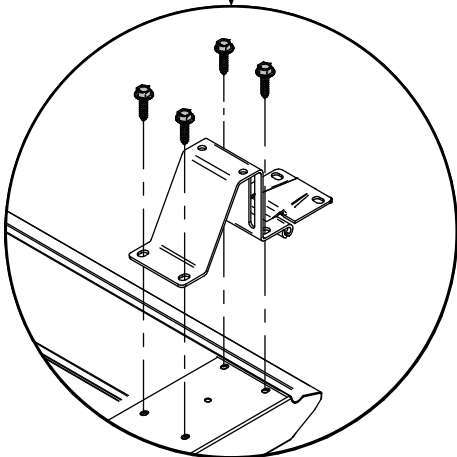
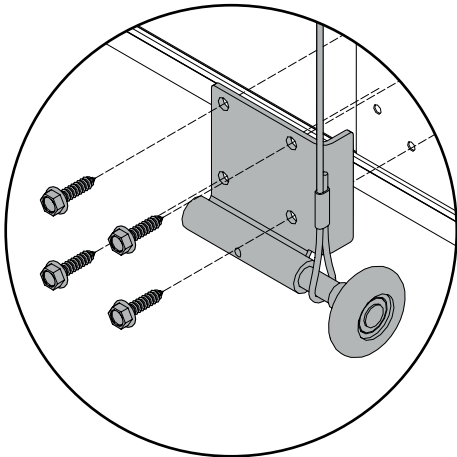

Insert the roller into the track and secure the sliding bracket

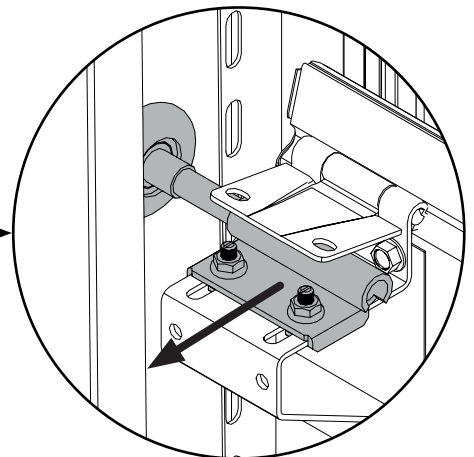
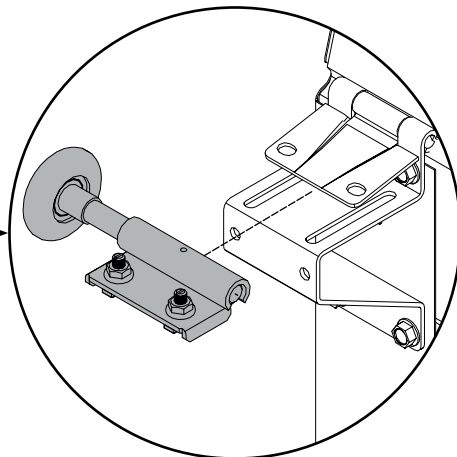
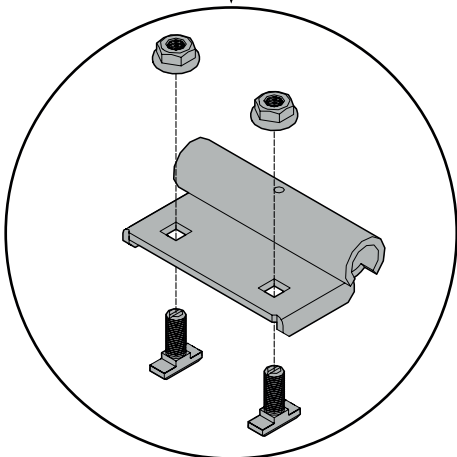

Lift the second panel into the opening and secure the brackets and roller, as per panel one

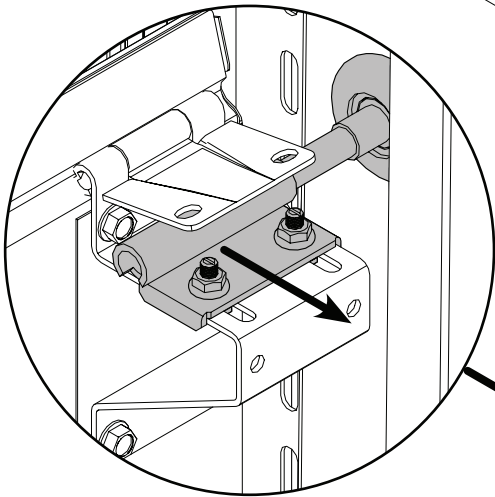
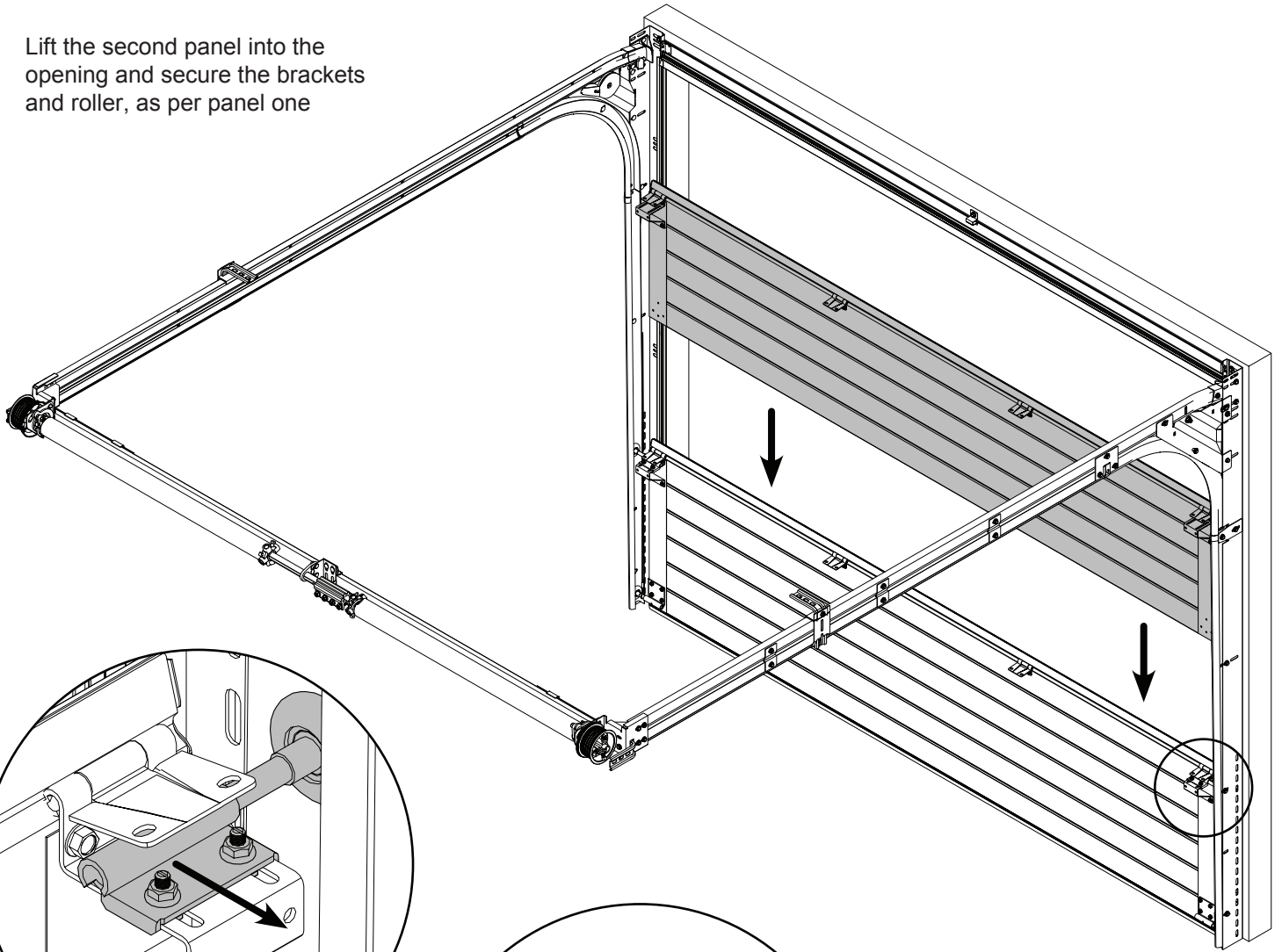

Ensure the roller is located within the track

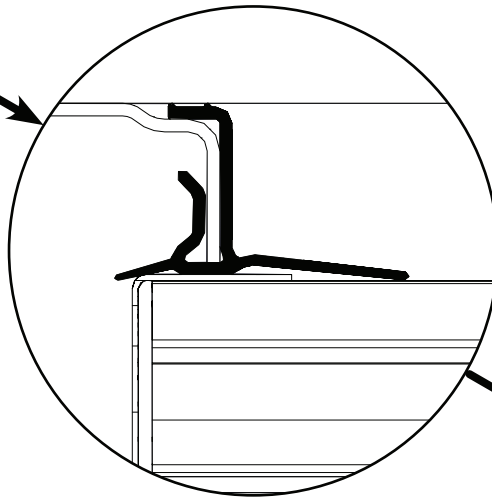

Check panels sit well with the weather seal on vertical tracks

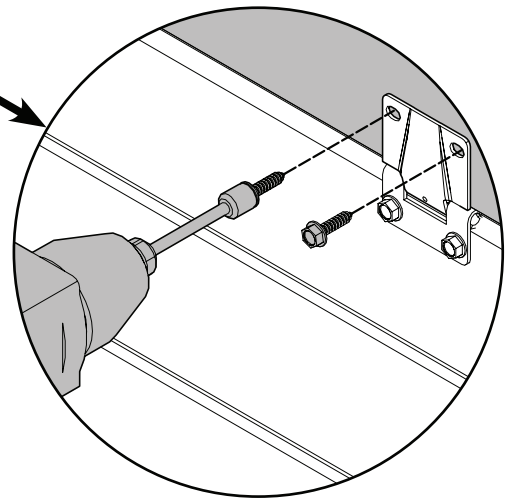

Secure central hinges

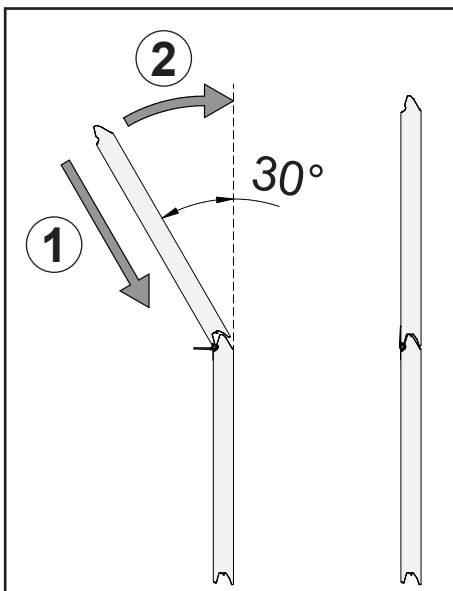

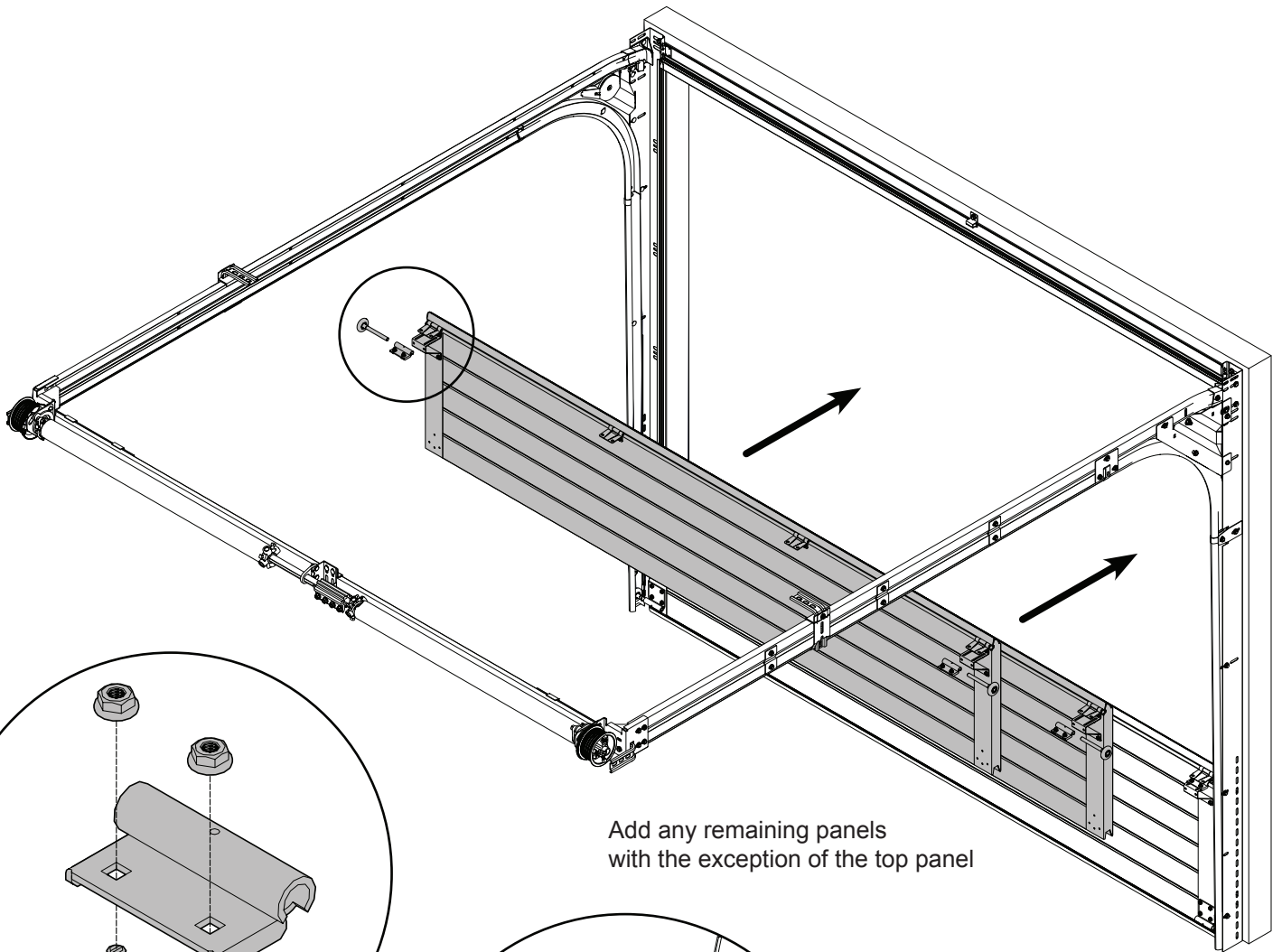

Add any remaining panels with the exception of the top panel

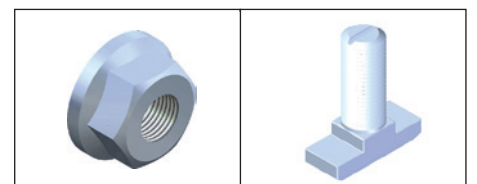
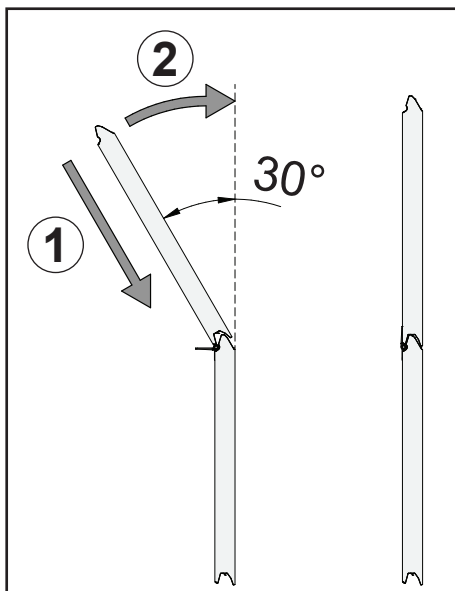
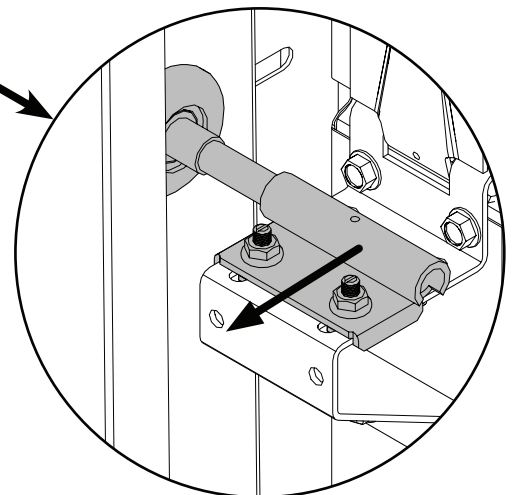
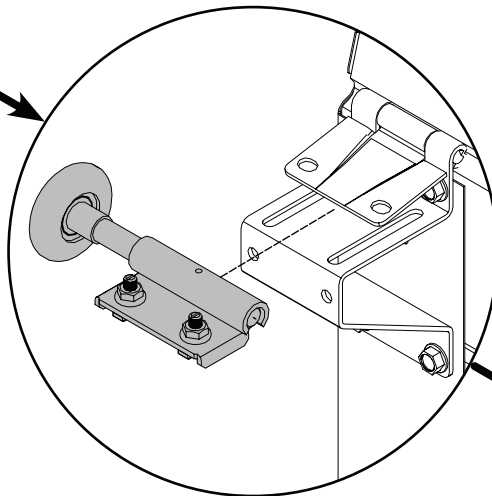
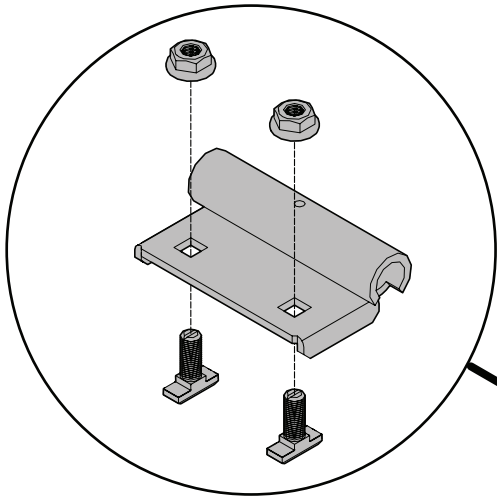

Lift top panel into opening

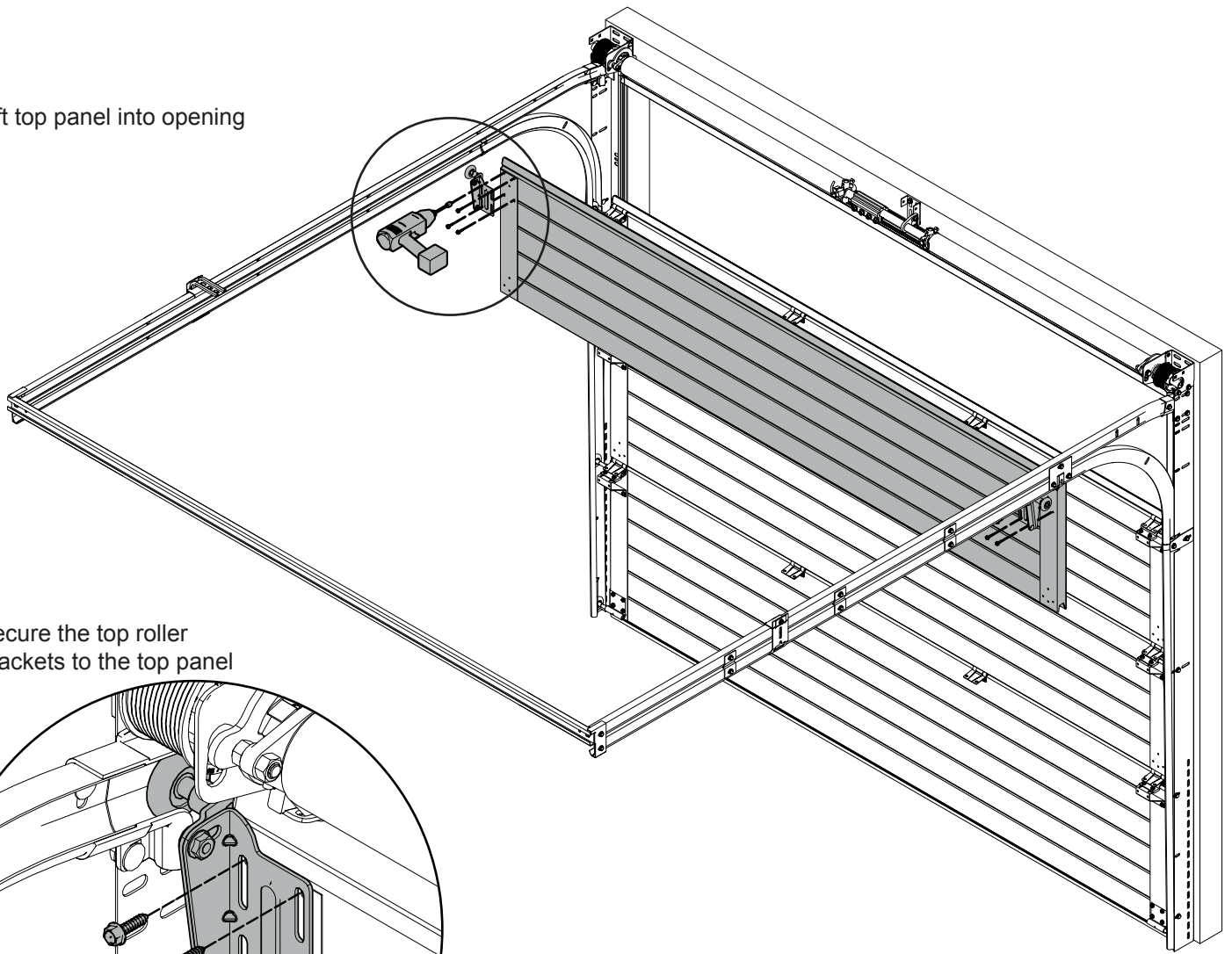

Secure the top roller brackets to the top panel

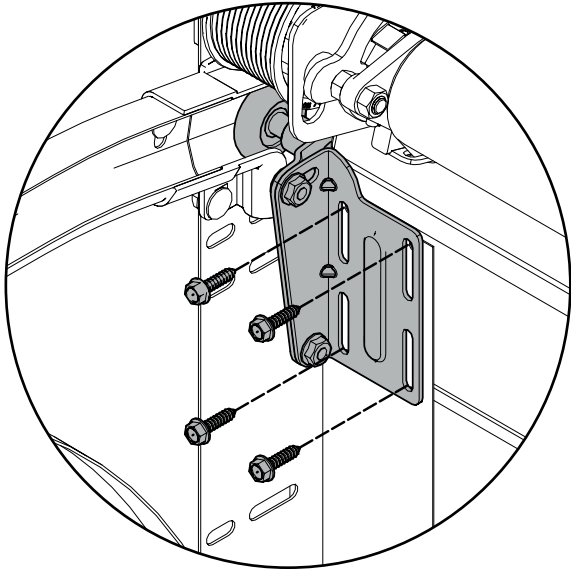

Secure any hinges similar to the other panels

Adjust the top roller for manual or electric operation

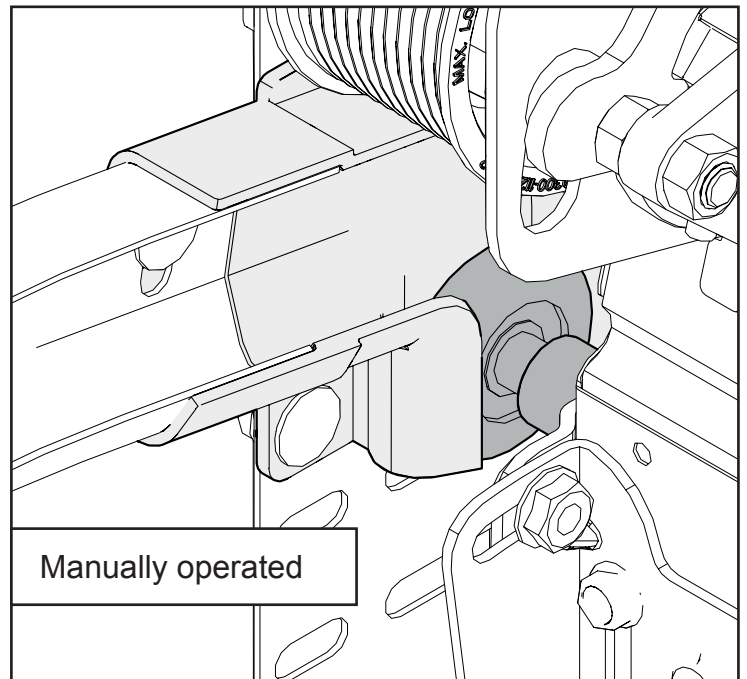
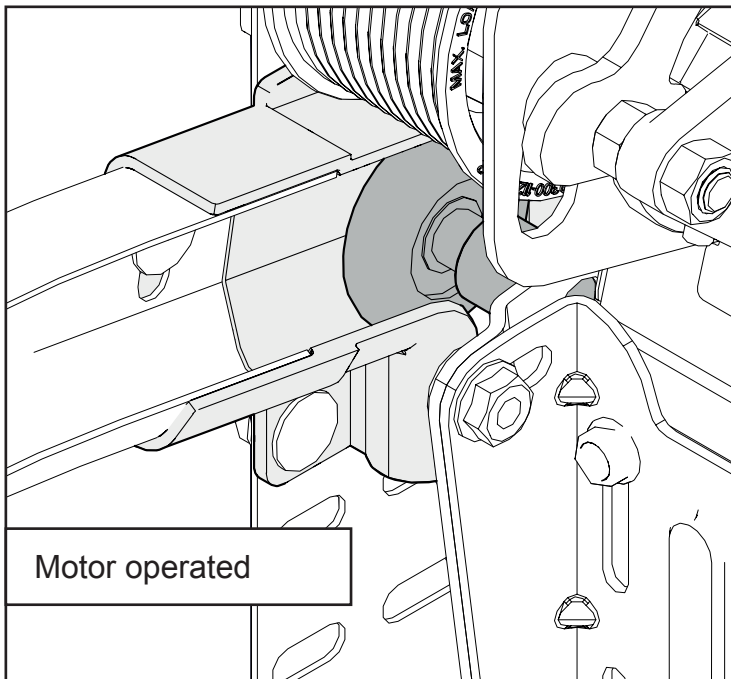

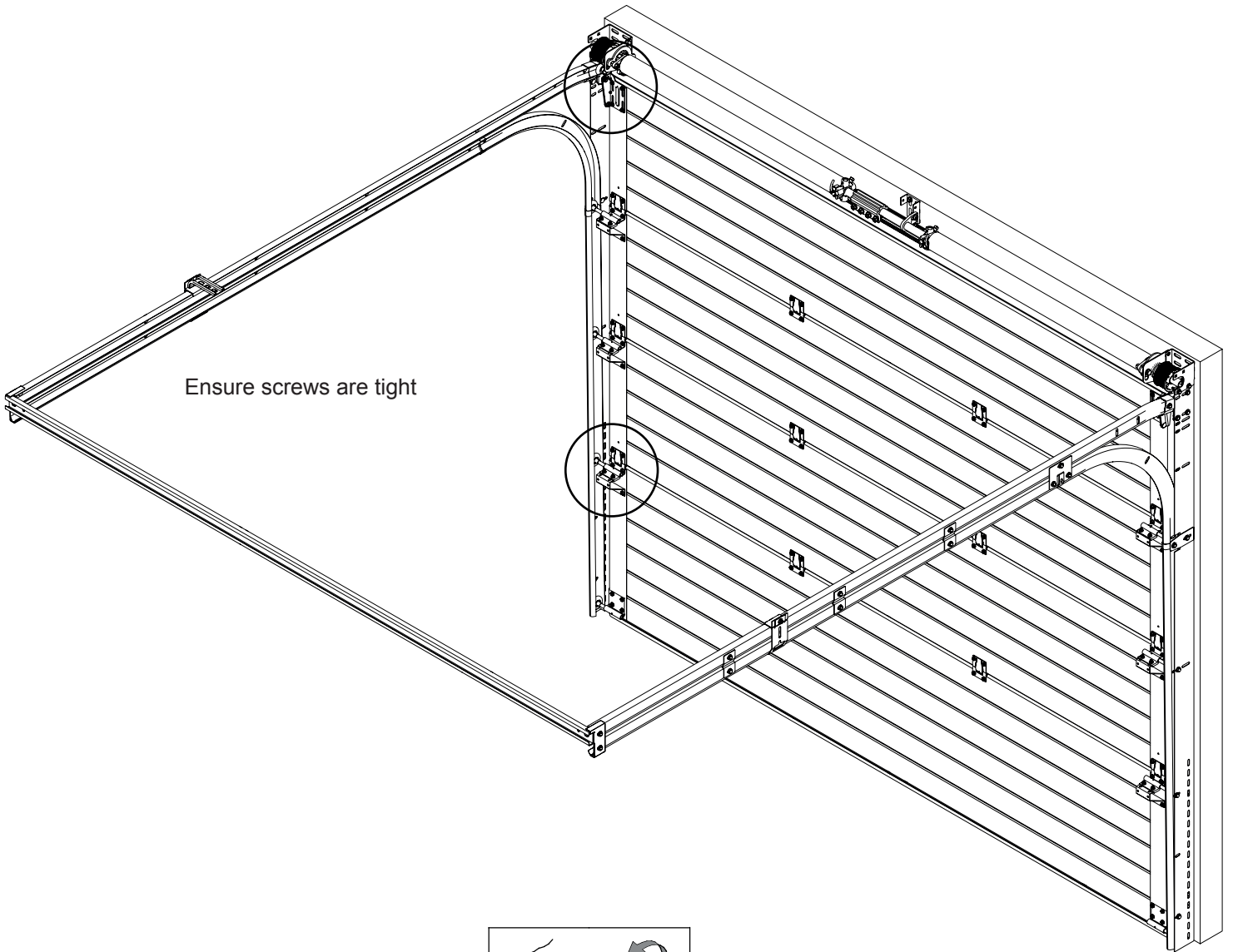

Ensure screws are tight

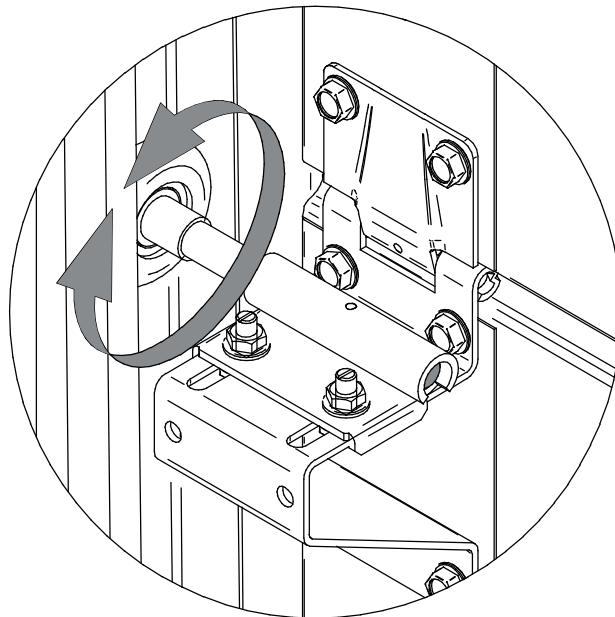
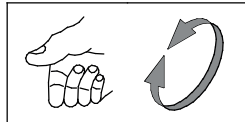

Ensure rollers are freely moving

Before tensioning the door, clamp the panels into the down position

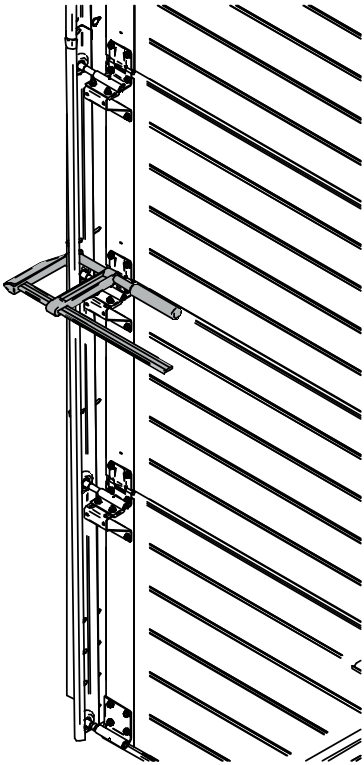
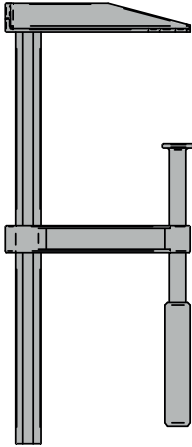

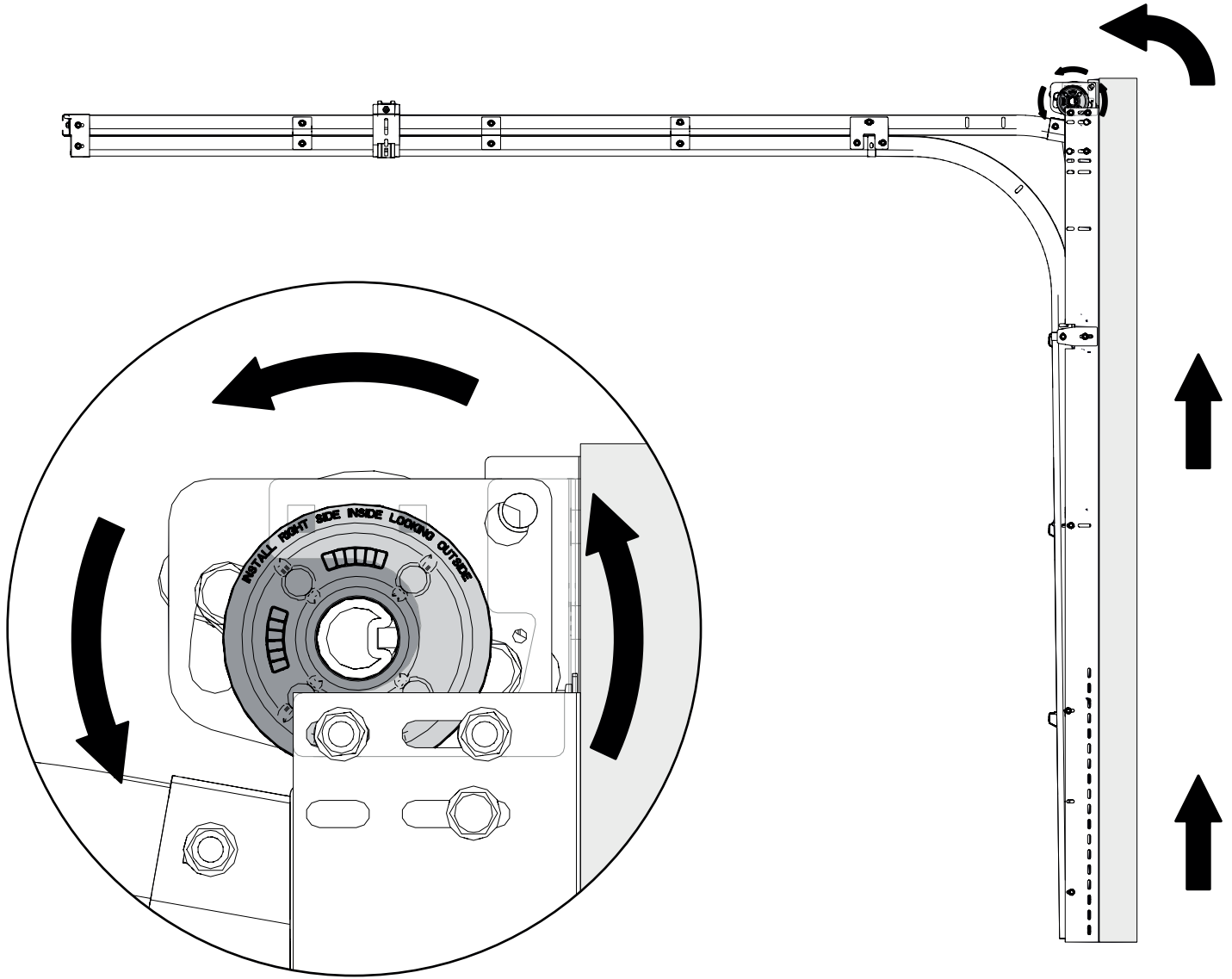

Ensure the cables fit neatly into the groove

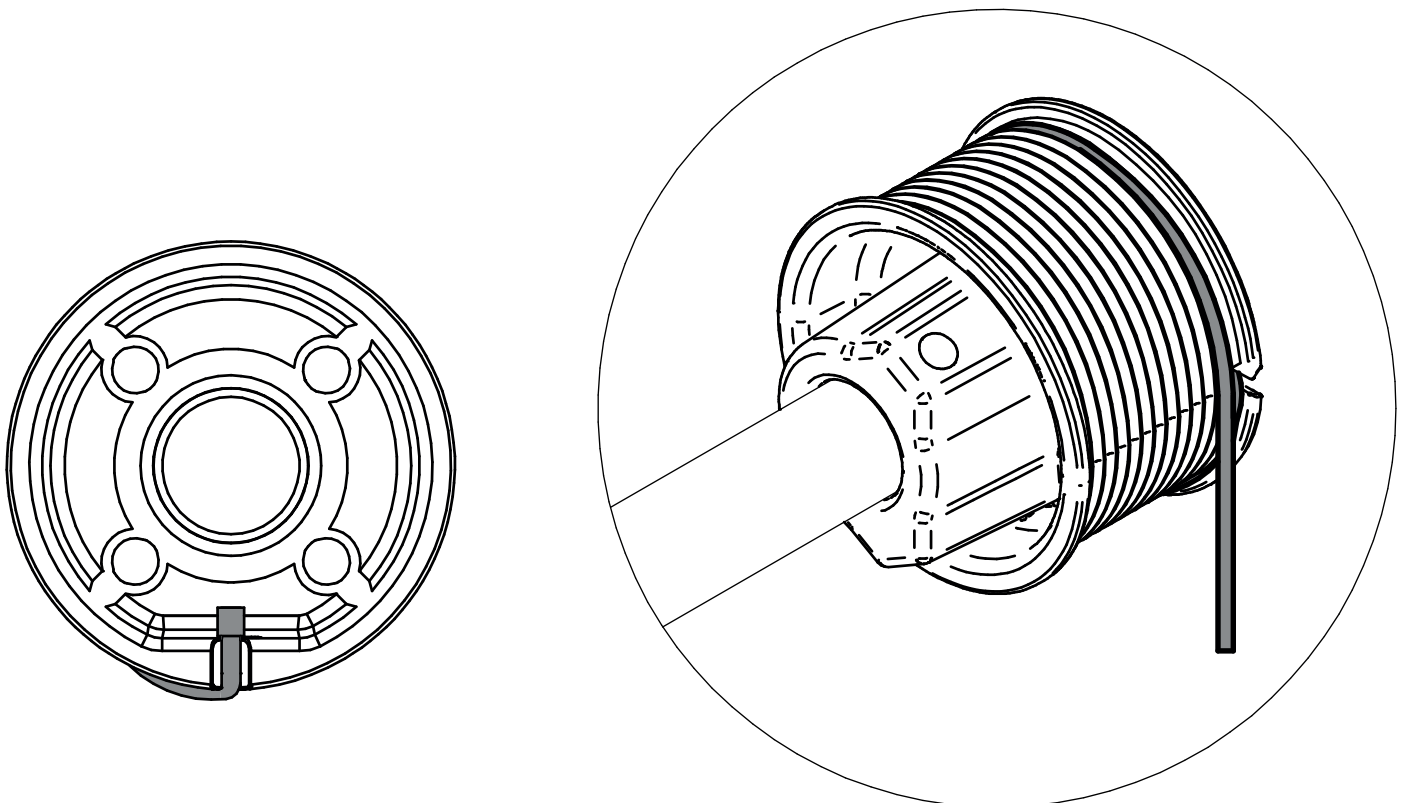

Locate the cable lug into the notch on the outside of the cable drum

Check paperwork or spring tension label located on the spring for number of turns.

When tensioning the springs take great care, improper tensioning could lead to the tensioning bars striking your body.

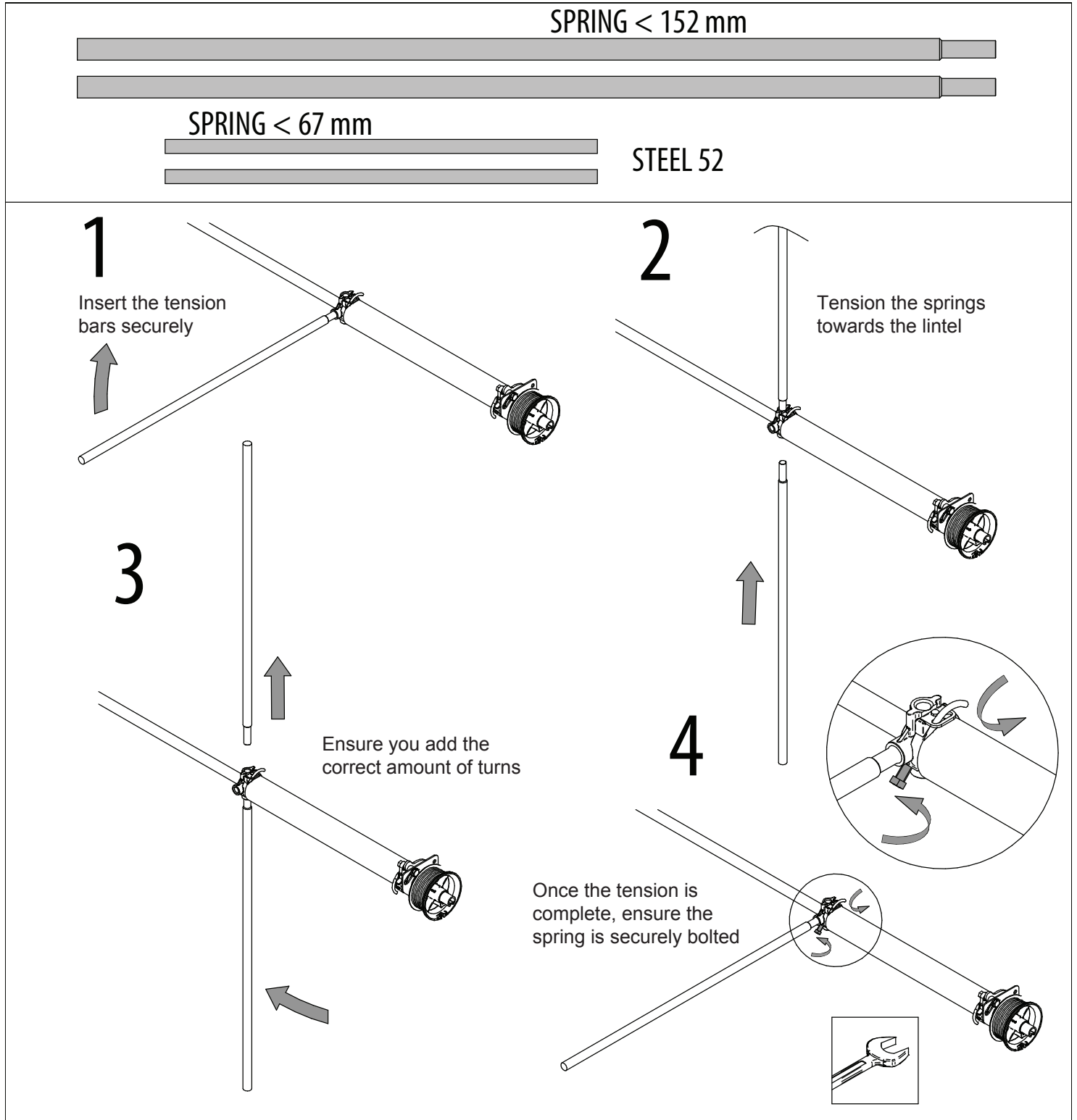

EN: Correct fastening of winding plug

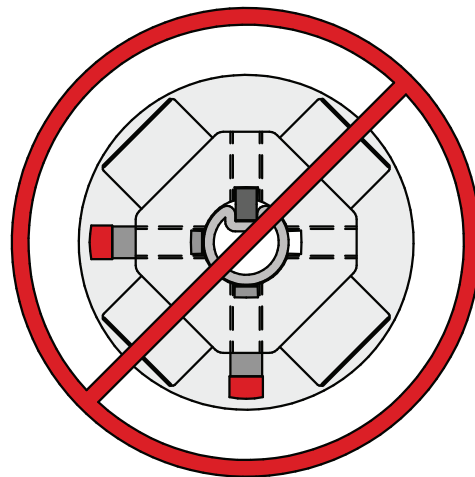
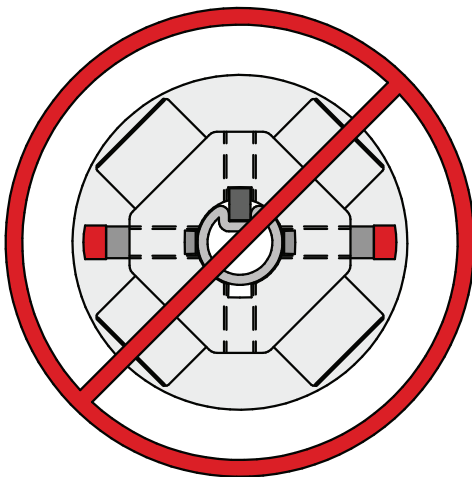
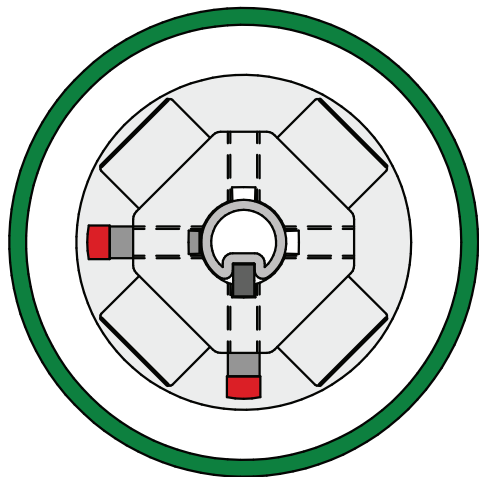

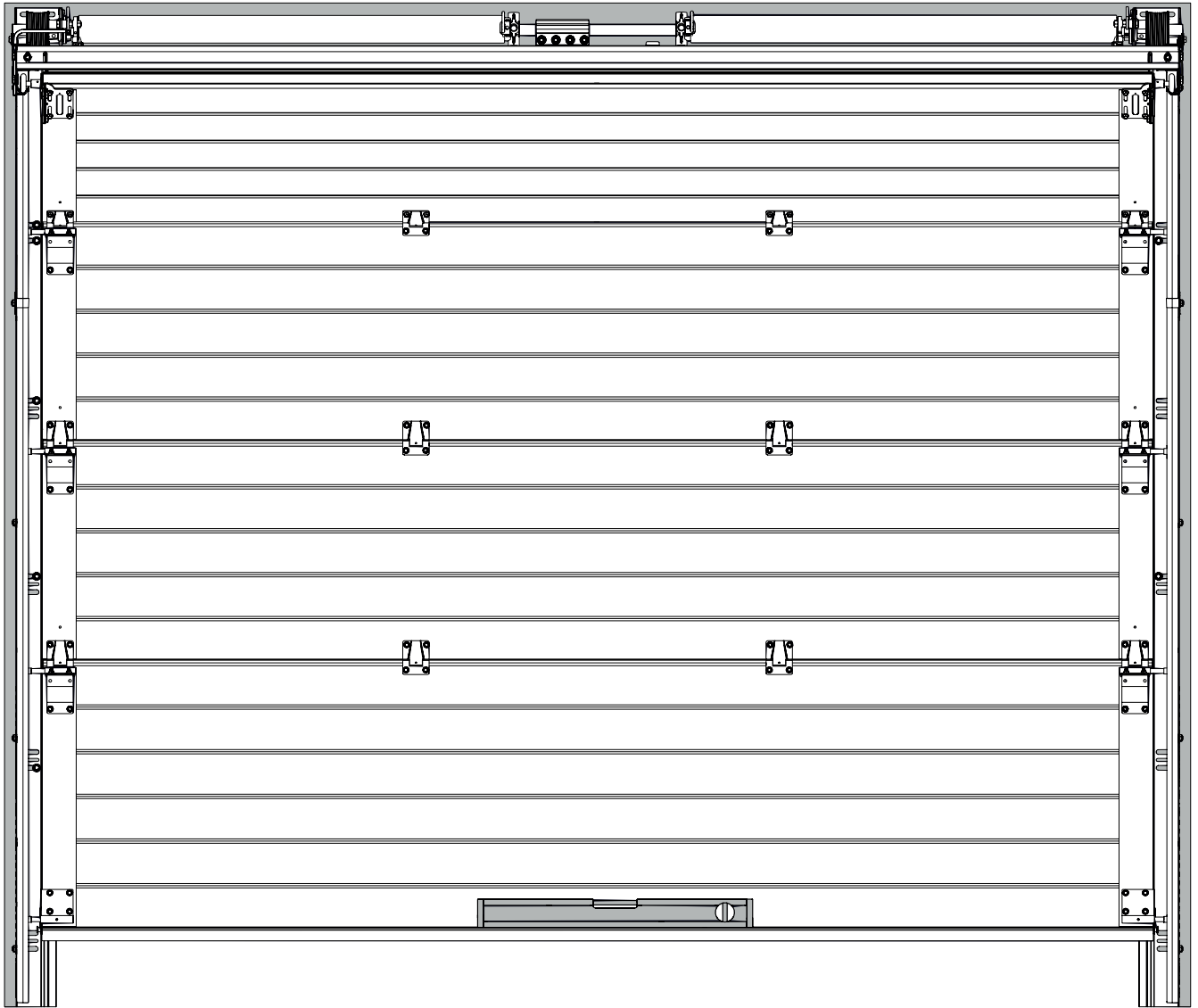

Once the tension is in place, check that the door is level.
Check the balance and adjust if necessary

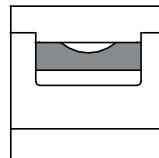
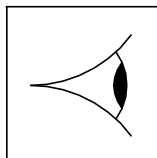

Reveal Options

Executive Framing Kit

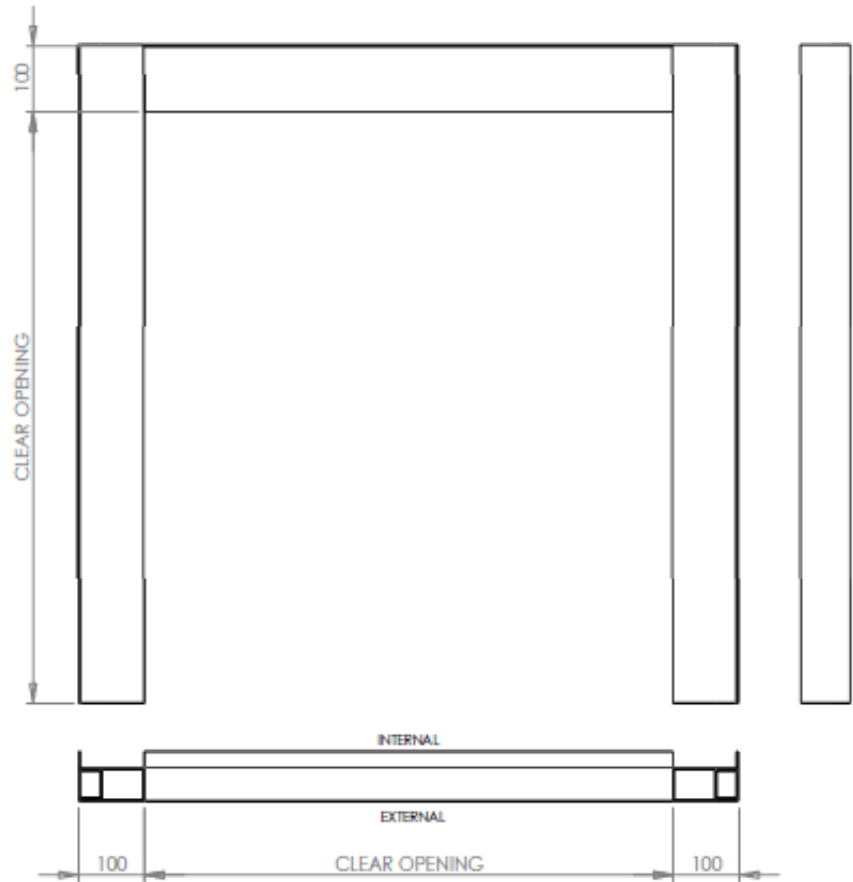
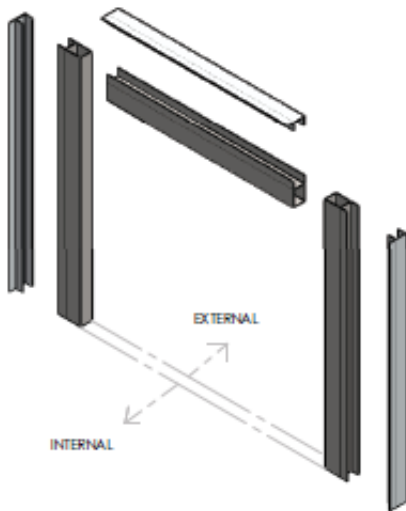
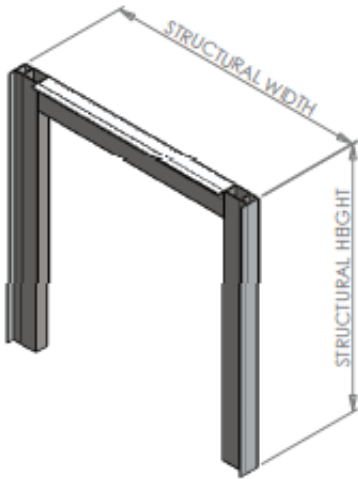

Reveal Brackets

Position 5 per side, secure each bracket with 2 M8 x 18 bolts and M8 serrated nuts

